

USA 250

World Stamp Exhibition



A proposal submitted by the
USA 250 World Stamp Exhibition Organizing Committee
of the Northeastern Federation of Stamps Clubs
to host an International Philatelic Exhibition in Boston

Presented to the
Board of Directors of the American Philatelic Society
Bellefonte, PA
January 15, 2015

Presented by the USA 250 World Stamp Exhibition Organizing Committee:

Dr. Yamil Kouri, FRPSL

Nancy B. Z. Clark, FRPSL

Mark A. Butterline

Steven C. Walske, FRPSL

Christopher Brouady

George S. Norton, Esq.

Michael Dixon, FRPSL, Consultant

Gordon C. Morison, Consultant

Charles Verge, FRPSC, Consultant

Private and Proprietary
Northeastern Federation of Stamp Clubs

Table of Contents

Requirements from the American Philatelic Society	5
A Proposal.....	6
Executive Summary	7
Exhibition Date	8
Location, location, location	8
The Theme: America’s 250th Birthday	9
Boston – A Major Metropolitan Area	10
Boston – Number One Destination for International Conventions.....	11
Attractions and Amenities.....	12
Population within a Day’s Drive.....	14
A Broad Base of Philatelic Support	15
Northeastern Federation of Stamp Clubs	15
Spellman Museum of Stamps & Postal History	16
Local Stamp Clubs	17
APS Members	17
Beyond New England	18
Exhibit and Meeting Space	19
Exhibition and Bourse Space	20
Freedom from Contractor Restrictions	22
Meeting Space.....	22
Ballroom for Opening Ceremonies & Palmares Dinner	24
Show Dining	25
Loading Bays	26
Boston Convention and Exhibition Center Expansion	27
Lodging.....	28
Existing Hotels.....	28
Hotels Under Construction	31
A Second Convention Center Hotel.....	31
Expected Hotel Rooms in 2026	32
Transportation/Logistics	33
International Air Access	33
Non-direct International Air Access	34
Customs.....	34
National Air Access	35
Regional Air Access	35

Regional / National Train Access	36
Local Train Access	37
MBTA Subway and Bus Access	38
Track 61	39
Inter-City Bus Services	40
Tourist Trolleys.....	40
Water Taxi	40
Ferries	40
Zip Cars.....	40
Bicycles.....	40
Driving	41
Parking	42
Invitation from Boston Convention Marketing Center.....	43
Invitation from Boston Mayor	44
Convention Center Commitment	45
Exhibit Frames	46
Decorator.....	46
Security	47
Youth and Beginner	47
Related Meetings and Conventions	48
FIP Centenary	48
Weather	49
Music and Art	49
Finances	50
Convention Center	50
Sponsorships	50
Dealer Bourse.....	51
Postal Administration Booths	51
Admissions.....	51
VIP Lounge/VIP Exhibit Club.....	51
Souvenirs.....	52
International Marketing & Technology	52
Donations	52
Financial Reporting.....	52
Preliminary Budget	53
USA 250 World Stamp Exhibition Organization	54

Volunteers	54
Letters of Support	54
Geographical Distribution of Philatelic Shows in the United States	54
Appendix A – Letters of Support.....	55
Athens Philatelic Society	55
Cape Cod Area Philatelic Group.....	57
Chelmsford Stamp Club.....	58
Fall River Philatelic Society	59
Massachusetts Postal Research Society	60
Mobile Post Office Society	61
The Philatelic Group of Boston	62
Rhode Island Philatelic Society	63
Rochester Philatelic Association.....	64
Southeastern Stamp Expo	65
Spellman Museum of Stamps and Postal History.....	67
Waltham Stamp Club.....	68

Requirements from the American Philatelic Society

While no formal RFP was published in the *American Philatelist*, based on the two previous international show RFPs¹ from the APS, a proposal for the 2026 show should include the following requirements for successful selection:

1. Come from a committee in a major metropolitan area.
2. The locale has a broad base of philatelic support that is willing and able to assist in running the show.
3. The infrastructure includes a facility with at least 400,000 gross square feet of exhibition and meeting space and access to and for international visitors.
4. Have 2,000 committable hotel rooms over eight show days (15,000 room nights).
5. Have an ability to provide 3,500 exhibit frames.
6. The proposal should include a preliminary budget showing usual show budget categories, including FIP requirements.
7. A strong level of commitment from the convention center and visitor's bureau is essential.
8. List of pertinent city/regions attractions and amenities, including public transportation.

¹ See *American Philatelist*, May 2005, page 401 and *American Philatelist*, January 1996, page 69 for the APS requirements for the 2016 and 2006 shows, respectively.

A Proposal

The Northeastern Federation of Stamp Clubs and the **USA 250 World Stamp Exhibition** Organizing Committee propose to stage an eight-day international philatelic exhibition in Boston during Memorial Day week in 2026. The site of the show will be the Boston Convention & Exposition Center (BCEC) in the Waterfront section of the city.

In a 350,000 square foot contiguous exhibition area, we anticipate hosting a large dealer bourse with approximately 200 booths, as well as a sizable foreign postal administration (65 booths) and society (60 booths) presence. Electronic dealerships conceivably will comprise another element of the bourse with 3-D displays of material.

There will be an open competition of approximately 3,500 frames, plus other special/court of honor exhibits, as well as a large literature competition. The organizers anticipate that the literature competition will require support for digital and paper entries and will enthusiastically support both formats. In addition, there will be a gallery of rarities and literature excerpts displayed in digital format on screens and pillars on the show floor, as well as digitally enhanced postal administration kiosks.

We plan on hosting between 200 and 300 society/organization meetings and will provide approximately 40 meeting rooms of various sizes at the BCEC. A large opening ceremony and closing palmares dinner will be staged using the BCEC's banquet room facilities.

The organizing committee believes that a truly international philatelic exhibition requires the sanction of an international governing body, so as to ensure that the international exhibition's prizes and medals are recognized as such. The organizers will work with the American Philatelic Society to obtain a patronage arrangement with the Fédération Internationale de Philatélie (FIP) or other suitable international philatelic organization that may exist at the time of the show.

The supporting details for this bid are presented below.

Executive Summary

Every ten years an international philatelic exhibition is held in the United States under the patronage of the FIP. After the initial show was held in 1913 in New York, all subsequent full American international shows have been in years ending in 6 or 7. The next four American internationals, held in 1926, 1936, 1947 and 1956, were also held in New York. Starting in 1966, American internationals were staged outside of New York. These were SIPEX in 1966 in Washington, DC, Interphil in 1976 in Philadelphia, Ameripex in 1986 in Chicago, Pacific in 1997 in San Francisco, and Washington 2006 in Washington, DC. The 2016 show is scheduled to return to New York, after a 60-year interval.

The Northeastern Federation of Stamp Clubs now proposes to host the first international stamp show in Boston in 2026 under the name **USA 250 World Stamp Exhibition**. The main reasons in favor of Boston's choice follow:

The year 2026 will mark the 250th anniversary of American independence. Boston and its surrounding communities played a major role in establishing this independence, both politically (Boston Massacre, Boston Tea Party, the Massachusetts Delegation to the Continental Congress) and militarily (Lexington and Concord, Battle of Bunker Hill, and Siege of Boston). Having the 2026 international in Boston will give visitors (philatelists, as well as accompanying family members) the opportunity to experience this significant anniversary in the city and state where so many significant events that led to our country's founding occurred. This will be at a time when interest in events related to the American Revolution and our colonial past will be at its height. Much like the Interphil show that took place in Philadelphia in 1976 during the country's Bicentennial celebrations, the proposed **USA 250 World Stamp Exhibition** will be an appropriate tribute to the country on its 250th anniversary. This will be the major theme of the show.

New England has hosted many successful APS StampShows (Boston, Hartford [twice] and Providence). We have an active federation of 36 stamp clubs, with deep experience in running a successful annual World Series of Philately show.

We now have an excellent set of facilities to host such a show at the Boston Convention and Exhibition Center (BCEC). Their web site indicates their decision to keep pace with the most advanced technology services of any convention facility in the world, including state-of-the-art networking, free Wi-Fi, building-wide cell phone coverage, teleconferencing and videoconferencing. With technology changes coming fast and furious, we can depend on them to keep pace (www.signatureboston.com/bcec/technology.aspx - sthash.rEC7bvK9.dpuf). In addition, unlike many sites, the requirement to use unionized services is at a minimum.

Boston also has a superior transportation infrastructure with a completed "Big Dig" highway system; a completed high-speed rail link connecting Boston to New York, Philadelphia and Washington; and a mass transit system that includes direct links between Boston Logan International Airport, the BCEC, and the Governor Michael S. Dukakis Transportation Center at South Station, the largest railroad station and intercity bus terminal in Greater Boston and New England's second-largest transportation center.

Given the above, on May 2, 2010 Northeastern Federation of Stamp Clubs President Mark Butterline appointed Nancy Clark, Yamil Kouri, and himself to a committee to study the feasibility of staging the 2026 international philatelic exhibition in Boston. On May 5, 2013 their feasibility report was approved by the Federation Board of Directors and an Organizing Committee appointed. Their proposal report (this report) was approved by the Federation Board of Directors on January 11, 2015.

Exhibition Date

Traditionally, the American international exhibition has been held during the Memorial Day week. This may be because convention and hotel facilities are not heavily used by business or government during holiday weeks. This usually means that facility availability is greater, while the charges for such facilities are less.

Monday, May 25 is Memorial Day in 2026. For an eight-day show this would mean an opening day on Saturday, May 23 and a closing day on Saturday, May 30. Four setup days would precede the show opening, with two breakdown days following the close of the show. Thus, the BCEC exhibition area would need to be reserved from Tuesday, May 19 through Monday, June 1, 2026.

Location, location, location ...

The proximity of the Boston Convention and Exhibition Center (BCEC) to Boston Logan International Airport and the city of Boston is the closest of any large stamp show ever held in the United States, and of any FIP show in recent memory. The airport traffic summary of July 2014 showed the airline traffic served the area with well over 35,000 total flights per month, domestic and international. The exhibition hall is less than a mile and a half, highway driving distance, from Boston Logan International Airport.

Our exhibition center is also within half a mile of some of Boston's most popular attractions and restaurants. Served by tourist trolleys and a Massachusetts Bay Transportation Authority (MBTA) stop, the convention center offers convenient accessibility to the heart of the city of Boston. With a large number and range of hotel rooms available in close proximity, the exhibition center reduces the show-hotel-city commuting time to an absolute minimum.

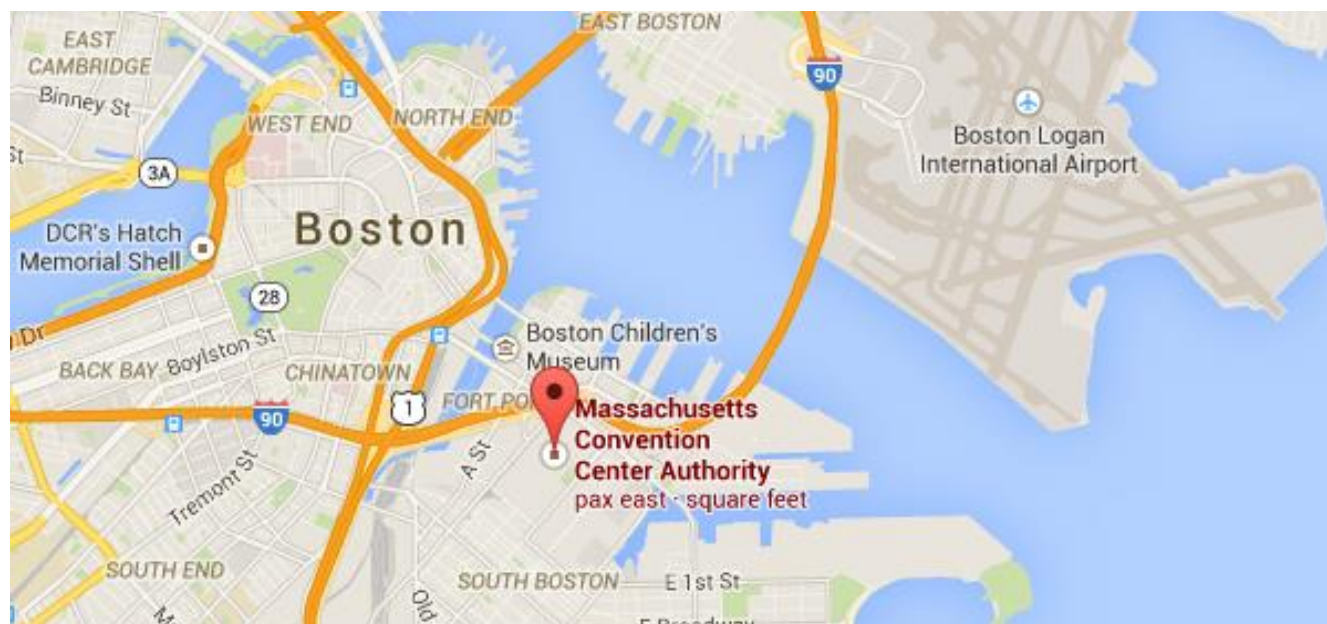

It was recently announced that Boston was chosen by the US Olympic Committee as the site to be nominated by them for the 2024 Olympic Games, beating out Los Angeles, San Francisco and Washington, DC.

The Theme: America's 250th Birthday

No city in the United States is more closely associated with the American independence movement than Boston. The pro-independence sentiment in the region dates back to the mid-1760s and had numerous manifestations, such as the Boston non-Importation agreement (1768), and the Boston Tea Party (1773). It culminated in the Battles of Lexington and Concord (1775), immediately followed by the Siege of Boston and the Battle of Bunker Hill. All of these events and places are part of a living freedom museum and can be visited in the Boston area. In addition, there are more colonial-era sites in and around Boston than in any other major American city. Boston is therefore the ideal location for an international exhibition commemorating America's independence.



USS Constitution and Bunker Hill Monument

Boston – A Major Metropolitan Area

Boston is the capital of and largest city in Massachusetts, and is one of the oldest cities in the United States, founded in 1630. The largest city in New England, Boston is regarded as the unofficial “Capital of New England” for its economic and cultural impact on the entire New England region. The city proper, covering just 48 square miles, had a population of 617,594 according to the 2010 U.S. Census. Boston is also the anchor of a substantially larger metropolitan area called Greater Boston, home to 4.5 million people and is considered the tenth-largest metropolitan area in the United States. Greater Boston as a commuting region is home to 7.6 million people, making it the fifth-largest Combined Statistical Area in the United States.

In 1630, Puritan colonists from England founded the city on the Shawmut Peninsula. During the late 18th century, Boston was the location of several major events during the American Revolution, including the Boston Massacre and the Boston Tea Party. Several early battles of the American Revolution, such as the Battle of Bunker Hill and the Siege of Boston, occurred within the city and surrounding areas. Through municipal annexation, land reclamation, and population growth, Boston has expanded beyond the peninsula. After American independence was attained, Boston became a major shipping port and manufacturing center, and its rich history now helps attract many tourists, with Faneuil Hall alone attracting over 20 million visitors every year. The city was the site of several firsts, including America’s first public school, Boston Latin School (1635), and the first subway system in the United States (1897).



With many colleges and universities within the city and surrounding area, Boston is an international center of higher education and a center for medicine. The city’s economic base includes research, manufacturing, finance, IT, and biotechnology. As a result, the city is a leading finance center, ranking 12th in the Z/Yen top 20 Global Financial Centers. While Boston has one of the highest costs of living in the United States, it remains high on world livability rankings, ranking third in the United States and 36th globally, according to Mercer. Boston also has one of the lowest crime rates among large metropolitan areas in the United States.

Boston – Number One Destination for International Conventions

Boston is also ranked as the #1 destination in the country for international conventions (per International Congress and Convention Association's *2013 ICCA Statistics Report – Country and City Rankings*). Diplomatically, Boston hosts many international diplomatic representatives (list below).

Consuls of FIP Countries in Boston

(located mostly in Back Bay and the Financial District):

- Brazil (Boston)
- Canada (Boston)
- Chinese Taipei (Mission Taiwan Economic and Cultural Office) (Boston)
- Colombia (Boston)
- France (Boston)
- Germany (Boston)
- Greece (Boston)
- Ireland (Boston)
- Israel (Boston)
- Italy (Boston)
- Japan (Boston)
- Mexico (Mexico)
- Peru (Boston)
- Portugal (Boston)
- South Korea (Newton)
- Spain (Boston)
- Switzerland (Cambridge)
- Turkey (Boston)
- Venezuela (Boston)
- United Kingdom (Cambridge)

There are also honorary consulates from the following FIP countries:

- | | |
|----------------------|------------------------------|
| • Austria (Boston) | • Belgium (Boston) |
| • Bolivia (Boston) | • Bulgaria (Boston) |
| • Cyprus (Cambridge) | • Czech Republic (Wellesley) |
| • Denmark (Boston) | • Ecuador (Needham) |
| • Finland (Boston) | • Georgia (Cambridge) |
| • Hungary (Boston) | • Iceland (Dedham) |
| • Latvia (Needham) | • Luxembourg (Boston) |
| • Malta (Belmont) | • Monaco (Boston) |
| • Nepal (Boston) | • Netherlands (Boston) |
| • Norway (Boston) | • Pakistan (Milis) |
| • Poland (Cohasset) | • Romania (Concord) |
| • Slovakia (Weston) | • Sweden (Boston) |
| • Thailand (Boston) | |

Attractions and Amenities

In Boston:

[USS Constitution](#)
[Freedom Trail](#)
[Faneuil Hall and Quincy Market](#)
[Boston Tea Party Ships & Museum](#)
[Paul Revere House and Museum](#)
[Old North Church](#)
[Bunker Hill](#)
[Colonial Cemeteries](#)
[Boston Athenaeum](#)
[Mary Baker Eddy Library](#)
[Old State House](#)
[New England Aquarium](#)
[Fenway Park & Red Sox](#)
[Holocaust Memorial](#)
[Museum of Fine Arts \(MFA\)](#)
[Museum of Science](#)
[Boston Children's Museum](#)
[Institute of Contemporary Art \(ICA\)](#)
[Back Bay & North End](#)
[St. Stephen's Church](#)
[Theater District](#)
[Beacon Hill](#)
[Boston Common & Boston Public Garden](#)
[Boston Public Library](#)
[Boston Harbor Islands & Cruises](#)
[JFK Presidential Library and Museum](#)
[Isabella Stewart Gardner Museum](#)
[Duck Boats](#)
[Boston Pops](#)
[Boston Symphony Orchestra \(BSO\)](#)
[Chinatown](#)

In Greater Boston:

[Lexington](#) and [Concord](#)
[Minuteman National Historical Park](#)
[Harvard Square](#) and [Harvard](#)
[MIT Museum](#) and [MIT](#)
[Fogg Museum](#) (Harvard)
[Widener Library](#) (Harvard)
[Busch-Reisinger Museum](#) (Harvard)
[Mount Auburn Cemetery](#)
[Arthur M. Sackler Museum](#) (Harvard)
[Harvard Museums of Natural History](#)
[Salem Maritime National Historical Site](#)
[Salem Witch Museum](#)
[Ralph Waldo Emerson House](#) (Concord)
[The Wayside](#) (Concord)
[Sleepy Hollow Cemetery](#) (Concord)
[Walden Pond](#) (Concord)
[Louisa May Alcott's Orchard House](#) (Concord)
[DeCordova Museum & Sculpture Park](#) (Lincoln)
[National Heritage Museum](#) (Lexington)
[Spellman Museum of Stamps & Postal History](#)
[Peabody Essex Museum](#)
[Plimoth Plantation](#)
[Plymouth Rock and Mayflower replica](#)
[Longfellow's House](#) (Cambridge)

Outside Boston Area:

[Cape Cod](#) and [Provincetown](#)
[Martha's Vineyard](#) and [Nantucket](#)
[Whaling Museum](#) (New Bedford, MA)
[Sturbridge Village](#)
[Hancock Shaker Village](#) (Pittsfield, MA)
[Norman Rockwell Museum](#) (Stockbridge, MA)



1954 Meter from the Boston Public Library



Institute of Contemporary Art (ICA)



JFK Presidential Library and Museum

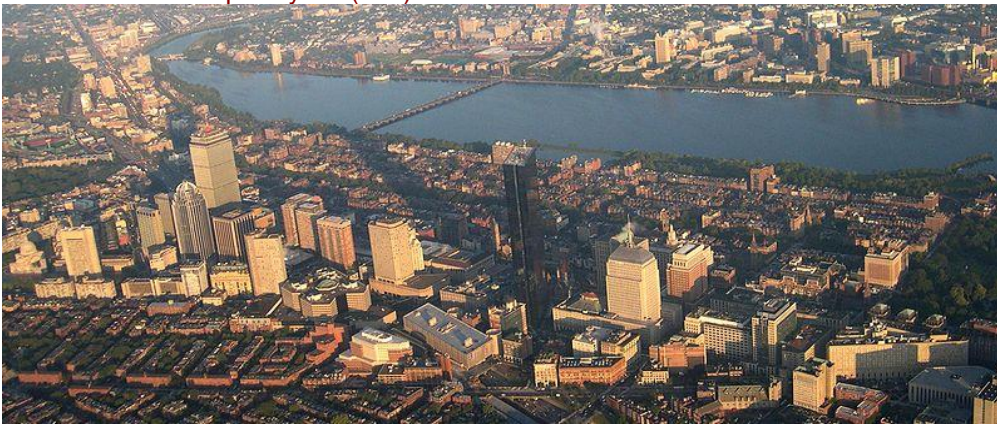

Back Bay



Museum of Fine Arts

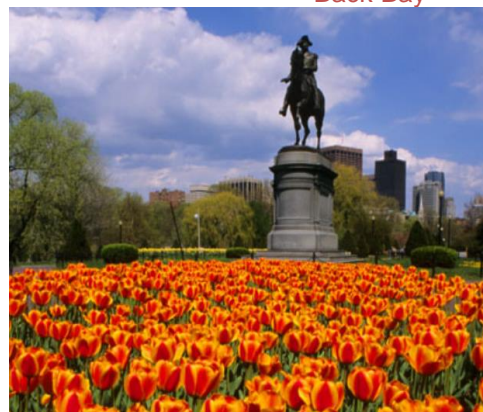

Boston Common (first public park in the nation)



Harvard Yard

Population within a Day's Drive

As of the 2010 census, over 85 million people live within a 500-mile radius of Boston; over 68 million in the United States (22.2% of the total USA population) and over 17 million in Canada (52.2% of the total Canadian population). The total population of New England is almost 14.5 million.

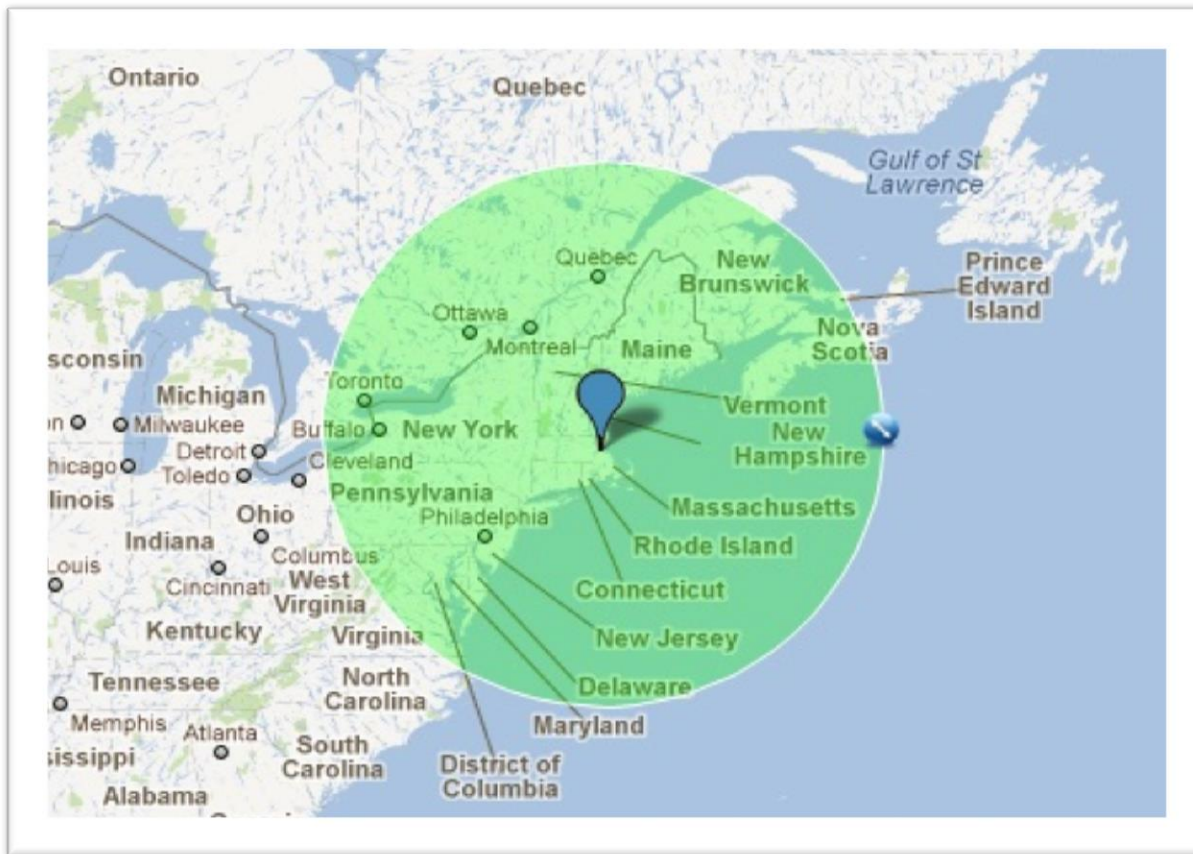

500 mile radius from Boston



A Broad Base of Philatelic Support

New England has long been known as one of the most active philatelic areas in the United States. Throughout the region there are literally dozens of stamp clubs and societies. Many of these groups sponsor their own shows, which range from small one day exhibitions and bourses to the former three day Boston Show (co-sponsored by the Boston Philatelic Society and the ASDA and subsequently taken over by the Northeastern Federation of Stamp Clubs).

Northeastern Federation of Stamp Clubs

In the autumn of 1977, James T. De Voss, Executive Secretary of the American Philatelic Society, met informally with a number of area stamp collectors to present the idea of forming a federation of stamp clubs in the northeastern part of the country. A steering committee consisting of six members from various stamp clubs was formed. This steering committee met several times during that year, and delegates from throughout New England attended the two organizational meetings. The second of these organizational meetings was held at the Cardinal Spellman Philatelic Museum (now the Spellman Museum of Stamps & Postal History) in Weston, Massachusetts. At that meeting, 33 delegates adopted a set of bylaws and the name: The Northeastern Federation of Stamp Clubs.

Now over thirty-five years old, The Northeastern Federation of Stamp Clubs has established itself as the leading philatelic organization in New England. Today the federation has 36 member clubs, with over 1,200 constituent members and continues to grow. Just since May 2014 three new clubs have joined the federation (i.e., Massachusetts Postal Research Society, Purgatory Stamp Club (Milford, NH), Upper Valley Stamp Club (Quechee, VT)).



The federation runs a large and successful youth program, as well as providing funding to other philatelic organizations (e.g., Spellman Museum, APRL, New York 2016). They have also staged New England's annual WSP show, Philatelic Show, since 1980. Unofficially known as "Boxborough" because it is staged at the Boxborough (MA) Holiday Inn, the show will be improved and expanded when it moves to the Boston Marriott Burlington in 2017.

The federation is a non-profit educational organization (per IRS) with over \$50,000 in assets, of which more than \$40,000 is in cash, with no liabilities. It will provide the initial deposit for our reservation at the BCEC.

The federation also owns 350 A-frames and a very well maintained marketing database containing 2,500 names that can be utilized by **USA 250 World Stamp Exhibition**.

Spellman Museum of Stamps & Postal History

The Spellman Museum, located on the campus of Regis College in Weston, is an independent, not-for-profit educational organization with a mission to promote knowledge and understanding of worldwide history and geography through the study of stamps, letters, and other artifacts of people's communication through the mail. This educational mission is advanced through: exhibitions; a resource center and library; programs for children, families, and adults; and, most recently, postal history symposiums held in conjunction with Philatelic Show.

Founded in 1960, the museum brought together the collections of Francis Cardinal Spellman, Archbishop of New York, and the National Philatelic Museum in Philadelphia. The collection now includes over 2,000,000 items, including those from President Dwight David Eisenhower, violinist Jascha Heifetz, and General Matthew Ridgway. The Spellman Museum is one of two public museums in the United States devoted to stamps and postal history, the other being the Smithsonian Institution's National Postal Museum.

The Spellman will provide office space for the organizing team before and after the show. They will also handle our credit card processing (not the APS).

USA 250 World Stamp Exhibition will utilize Spellman facilities to store exhibits before and after the show (i.e., before the opening, and after the closing, of the bin room). This might include the storage of domestic exhibits not carried by USA commissioners to the show and/or the post-show storage of exhibits for non-USA commissioners that, for whatever reason, are not returning to their home countries immediately after the show. These exhibits would be stored in dedicated, locked cabinets in the double-door, locked, fire resistant vault located in the basement of the Spellman Museum. The post show Lost & Found will be located at the museum. This commitment has been approved by the Spellman Museum board of directors.



Local Stamp Clubs

USA 250 World Stamp Exhibition enjoys wide support among local stamp clubs. These include:

- Waltham (MA) Stamp Club – Owners of the annual WALPEX show (the second largest show in New England), has agreed to provide full support to the show. See Appendix A for letter of support.
- Thames (CT) Stamp Club – Owners of the annual THAMESPEX show, have agreed to lend us their 80 A-frames to the show.
- Philatelic Group of Boston – Will provide leadership support, as well as volunteers to the show. See Appendix A for letter of support – See Appendix A for letter of support
- Fall River (MA) Philatelic Society – See Appendix A for letter of support.
- Cape Cod Area Philatelic Group – See Appendix A for letter of support.
- Chelmsford (MA) Stamp Club – See Appendix A for letter of support.
- Rhode Island Philatelic Society – See Appendix A for letter of support.

APS Members

This is the proportion of current APS members by state and by region: MA 3.19%, CT 1.89%, ME 0.67%, NH 0.9%, VT 0.35%, and RI 0.44% for a total membership in New England of 7.4%. If we add the other neighboring states within driving distance: NY 7.35%, NJ 4.14%, PA 5.58% the total percentage of APS members in the North East is 24.51%. This number is substantially higher if we include MD, DC, DE, etc., as well as the members in southeast Canada. **USA 250 World Stamp Exhibition** will be within driving distance of roughly one quarter of all APS members.

Beyond New England

In addition to our NEFSC community of RI, CT, NH, VT, MA and ME, hobby leadership in CA, OH, NJ, FL, TN, AL, SC, NC, GA, MO, and PA are eager to actively participate.

Both Nancy Clark and Yamil Kouri have numerous close contacts and positions in organized philately at the national and international level.



Nancy Clark has served as a Director and Treasurer of the APS and for the past 12 years has been the host of the APS Stamp Talk internet radio show. She is an accredited judge and has served on eight international juries, including Ameripex 86. She is a Fellow of the Royal Philatelic Society London and 1st Vice President of the American Philatelic Congress and has been awarded both the Ernest A. Kehr Award for her work with beginning collectors and the John N. Luff Award for service to philately, as well as the Southeastern Federation of Stamp Clubs Rowland Hill Award for her work to encourage philately in the southeast US. She is the Chair and President of the Spellman Museum of Stamps & Postal History, and serves on the Boards of six societies (PGB, MPOS, EFOC, AMC, MPRS, GPHS). She was President of Olymphilex 96, a FIP show mounted as part of the Cultural Olympiad of the Centennial Games.

Yamil Kouri is U.S. delegate and board member of the Federacion Inter-Americana de Filatelia (FIAP), Fellow of the Royal Philatelic Society of London (FRPSL), and numbered member of the Real Academia Hispanica de Filatelia. He is also a board member of the Postal History Society, American Philatelic Congress, and the Spellman Museum of Stamps & Postal History. In addition, he is a member of more than a dozen other national societies, and of course, one of the vice-presidents of the APS.

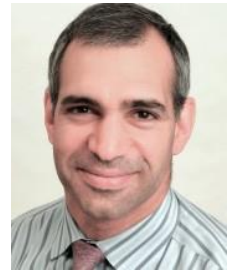

We have also appointed Michael D. Dixon, Ph.D., FRPSL, Charles J. G. Verge, FRPSC, and retired US Assistant Postmaster General Gordon C. Morison as International Consultants for **USA 250 World Stamp Exhibition**. Steven Walske has agreed to be the **USA 250 World Stamp Exhibition** Chief Financial Officer.



Morison



Dixon



Verge



Walske

Exhibit and Meeting Space

The Boston Convention and Exhibition Center (BCEC), located on the Boston Waterfront and next to the downtown, currently provides the services and facilities needed for an international show.



BCEC main entrance, overlooking the Boston Waterfront.



Aerial view showing BCEC rear entrance and parking lot, with downtown to the left.

Exhibition and Bourse Space

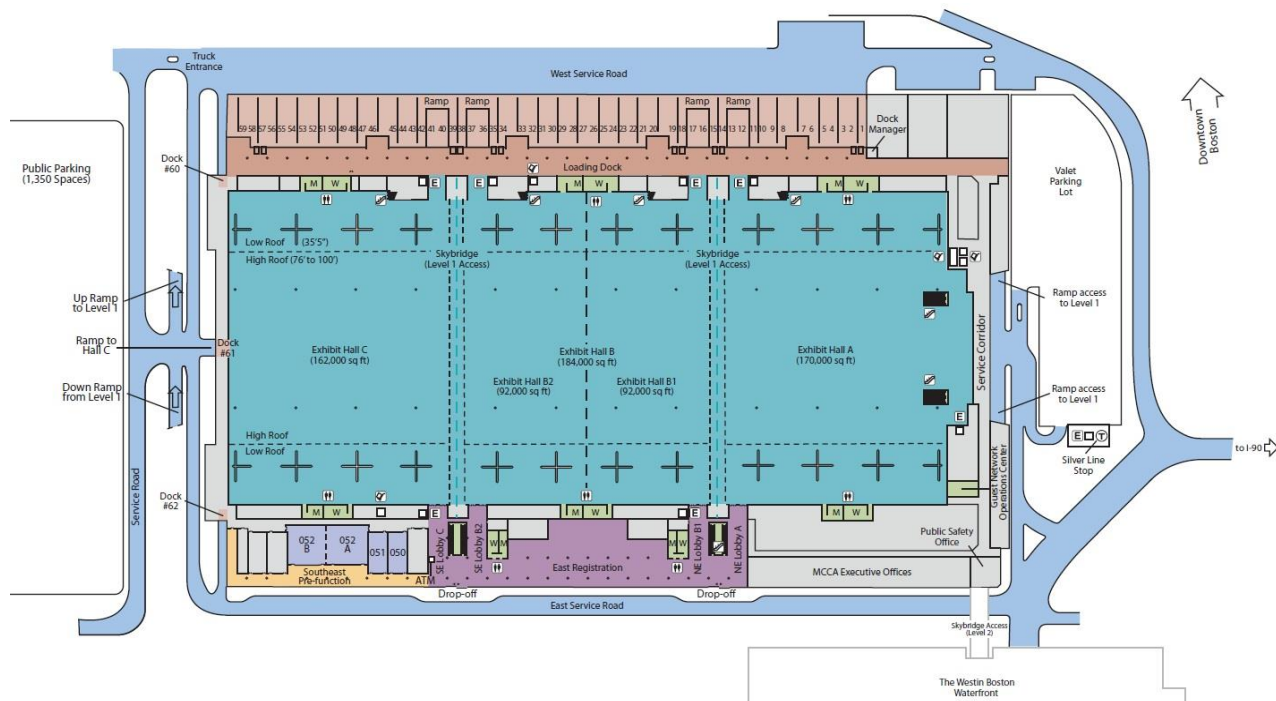

BCEC Exhibition Floor (Level 0)

The convention center currently has 516,000 square feet of contiguous exhibit space with minimal pillar presence (i.e., 60 feet gap using narrow diameter pillars – see picture on next page). Exhibit space is easily divided into 10 different configurations. There is 80,000 square feet of registration area (50,000 at the front and 30,000 on the east side).

The hall is a modern building of recent construction having opened in 2004. It is fully handicapped accessible. The facility has complementary Wi-Fi enabled Internet access throughout the building. There is also excellent cell phone coverage within the building (AT&T, Verizon, Sprint, T-Mobile). The building is currently undergoing its fifth technology upgrade.

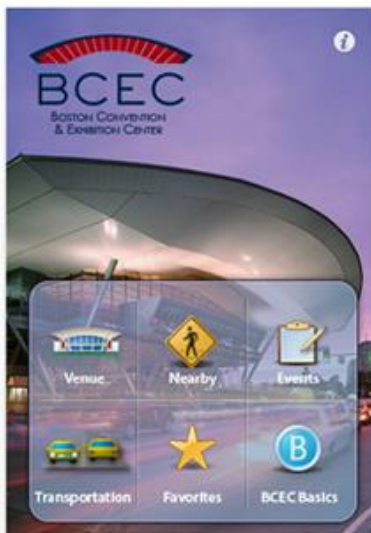

The convention center also offers its own customizable phone app. Click on image at left to play demo on YouTube. Under discussion is another app that guides users around the hall; offers links to the Freedom Trail and other historic venues; provides notification of meeting and scheduling changes at the convention center; and issues press releases in real time, promoting the excitement of **USA 250 World Stamp Exhibition**.

The exhibition floor has excellent climate control facilities (temperature and humidity). Walking access to any part of the building is no more than eight minutes. Access for load-in/out is excellent via covered bays with drive-in ability.

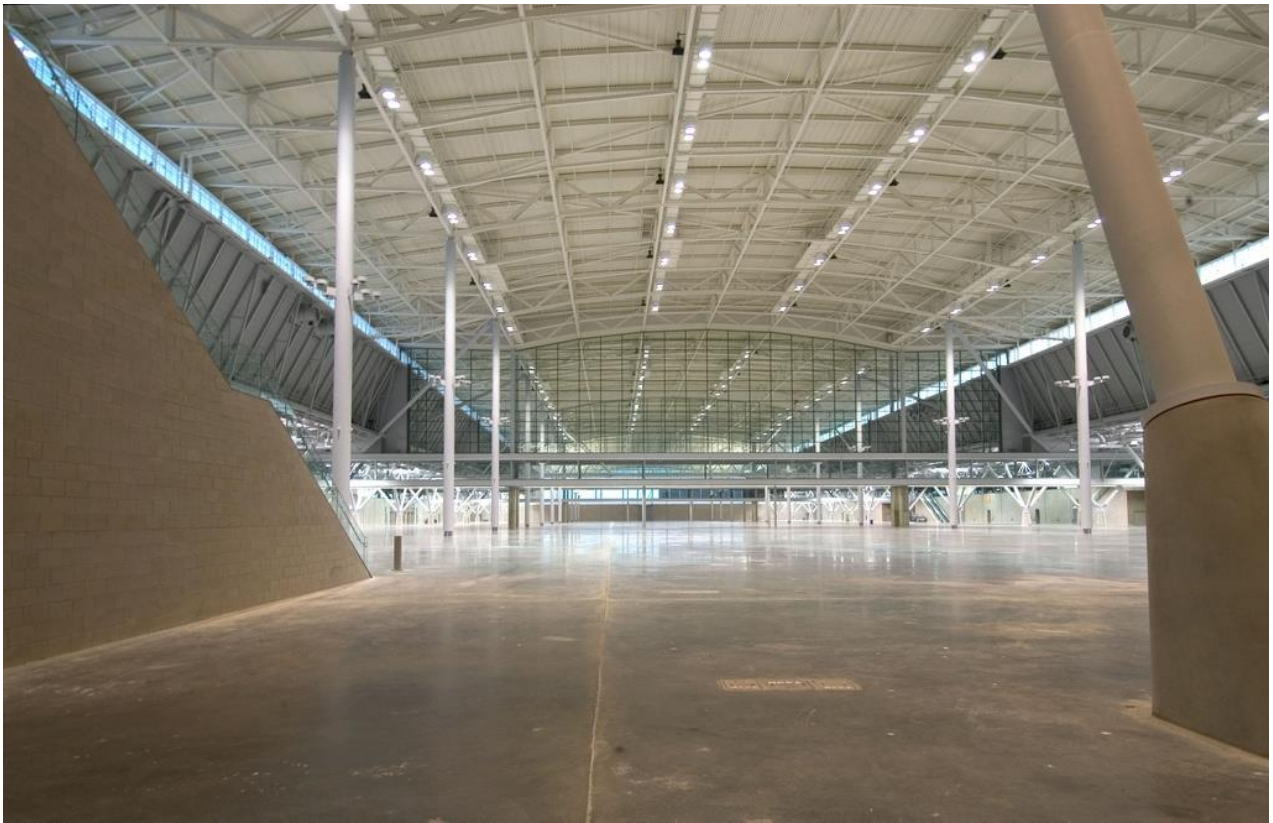

BCEC Exhibition Floor (Level 0)



BCEC Exhibition Floor (Level 0)

Freedom from Contractor Restrictions

There are no exclusives for general contractors or audio-visual suppliers (except when connecting to the house sound system). There are exclusive vendors for rigging and food & beverage. This allows the show organizers to seek and negotiate the most advantageous contracts for decorators, audio visuals, etc.

Meeting Space

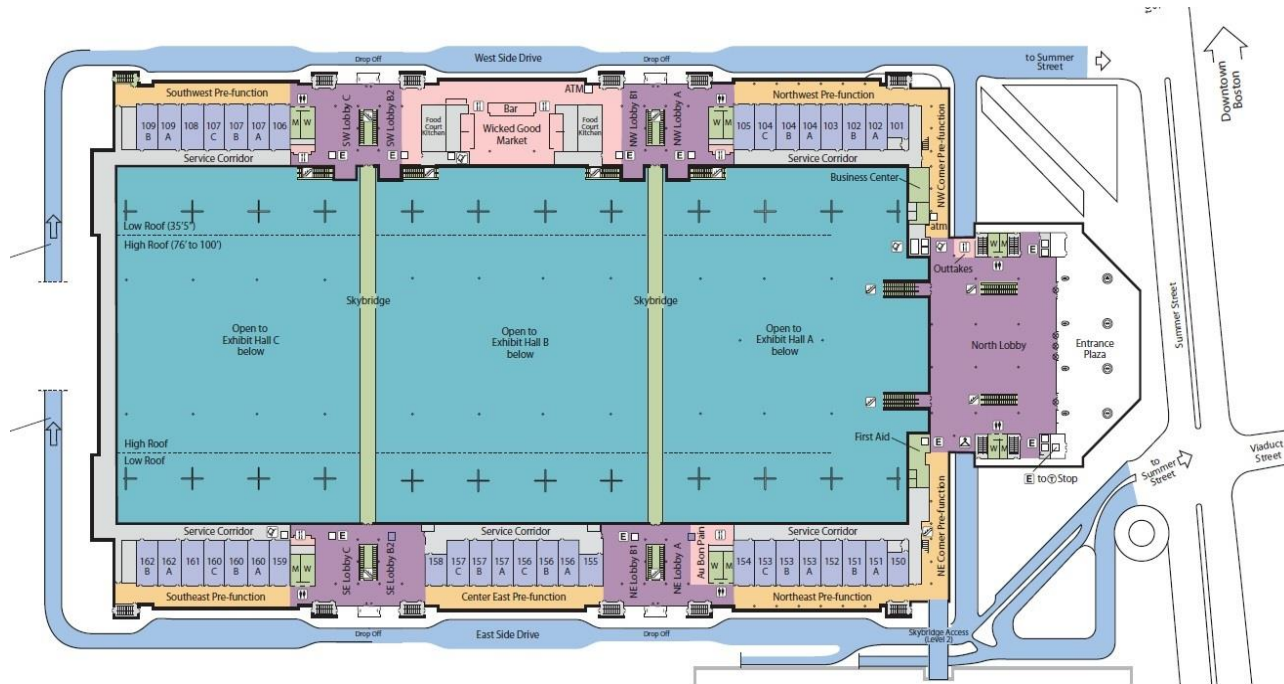

BCEC Meeting Rooms (Level 1) and Main Lobby & Registration Area

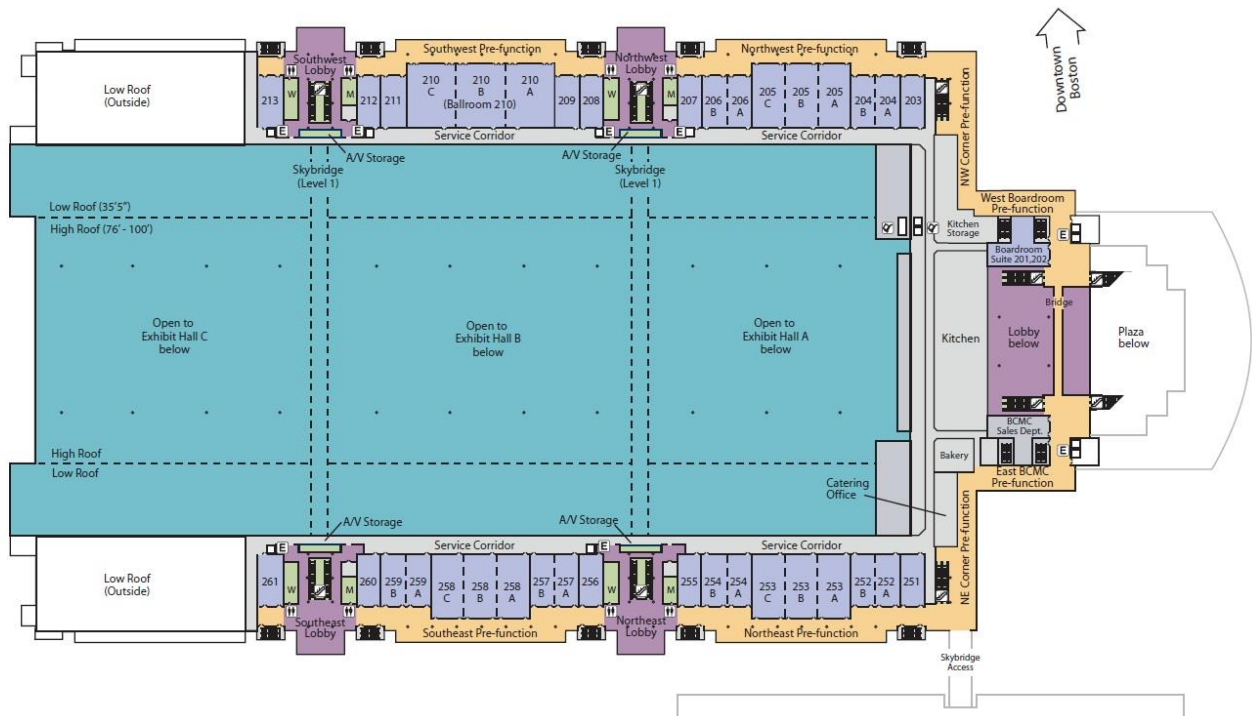

BCEC Meeting Rooms (Level 2)



BCEC Room 253A



BCEC Room 101

Boston's convention center has 160,000 square feet of flexible meeting space on two levels immediately above the exhibition floor. Configurations can accommodate large first day cover ceremonies and general meetings (1500 seats in theater layout), as well as the numerous smaller society meetings.

Ballroom for Opening Ceremonies & Palmares Dinner

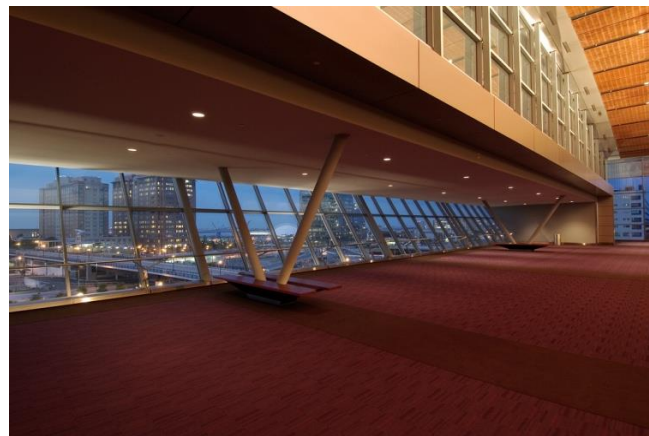
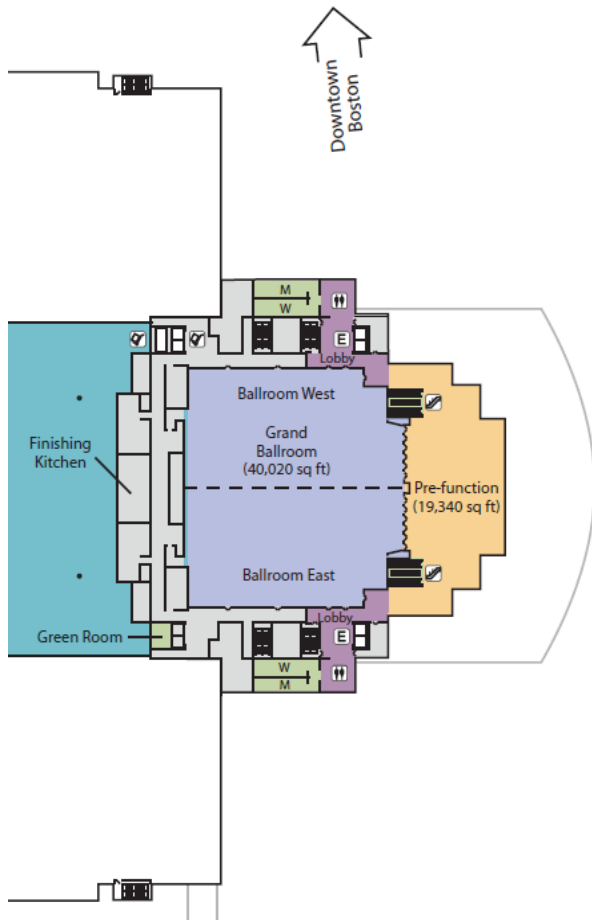

BCEC – Pre-function area



BCEC – Grand Ballroom

On the top level of the Boston convention center is a 40,000 square foot, column-free Grand Ballroom. A pre-function area immediately in front of the ballroom overlooks the waterfront area. Capacity is 3,120 diners.

Show Dining



BCEC – Wicked Good Market



BCEC – Wicked Good Market

For show dining there is a Wicked Good Market with multiple food options (including vegetarian and gluten-free), on the first level overlooking the exhibition floor (same floor as the meeting rooms). It has seating capacity for 700. The Samuel Adams Pub is adjacent. Exhibition floor food service will also be available. There is also a second dining option at the BCEC's Outtakes Quick Cuisine. In addition, the BCEC is surrounded by many restaurants, ranging from seafood served right on the waterfront, to street cafes, to authentic South Boston Irish pubs.

Loading Bays

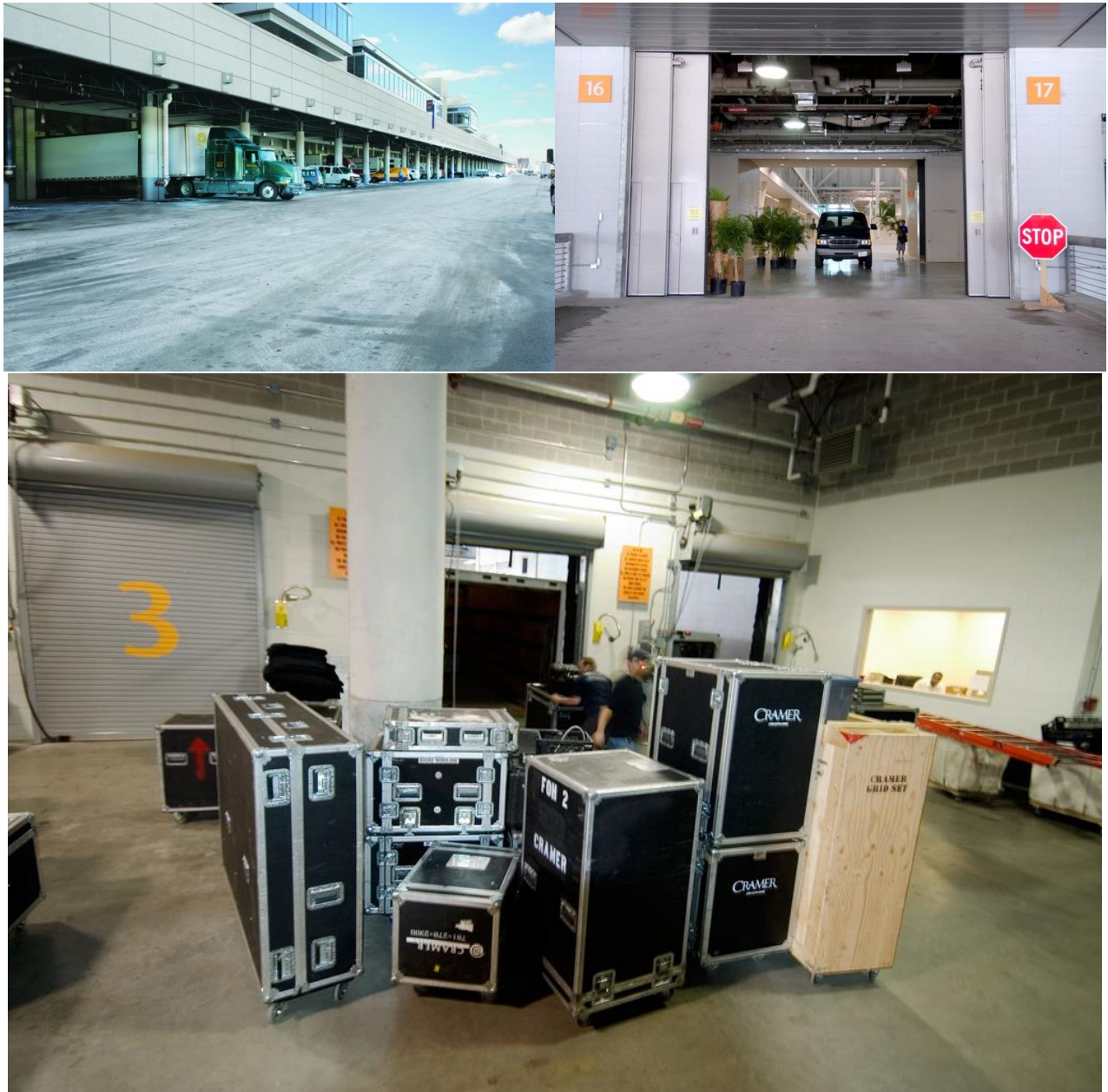

BCEC loading areas

There are two private ring roads around the BCEC. The west side currently has 62-covered loading bays and five elephant doors with direct exhibition floor access.

Boston Convention and Exhibition Center Expansion

On July 29, 2014 Governor Deval Patrick of Massachusetts signed the law to authorize and fund the expansion of the BCEC. This expansion will not require any increase in existing fees or taxes. The goal of the law is to make Boston one of the top five convention destinations in the country (currently Boston is a top ten convention destination).

Work on the expansion is now underway and is scheduled to be completed by 2020. Specifically this means:

Expansion plans will double the size of the current facility adding:

- 335,000 square feet of exhibit space (new total of 850,000 square feet).
- 100,000 square feet of meeting space (new total of 260,000 square feet in 121 meeting rooms).
- Additional column-free ballroom of 75,000 square feet (existing ballroom has 40,000 square feet).
- A second headquarters hotel with a minimum of 1,200 rooms, as well as approximately 100,000 square feet of meeting/function space (two hotels totaling 510 rooms are currently under construction).

Latest BCEC Expansion Developments:

- The convention center authority completed the purchase of 5.6 acres of land near the BCEC and construction of two mid-priced hotels (Aloft & Element hotels) started at the end of 2013.
- The convention center authority and the Massachusetts Port Authority have agreed to work cooperatively to build a second 1,200 to 1,500 room headquarters hotel for the BCEC.
- The convention center authority has recently acquired additional land to facilitate the construction of two parking facilities to support events at the BCEC.

Customer benefits of the BCEC expansion:

- Increased exhibit and meeting space will allow for larger events needing larger exhibit facilities and will increase date availability.
- The number of hotel rooms within a half-mile radius of the BCEC would increase by over 120%.

Lodging

Washington 2006 used 13,347 room nights at six hotels. However, the exhibition guaranteed rooms only at the headquarters hotel, the Renaissance Washington DC Downtown Hotel (the closest hotel to the exhibition site). This guarantee was easily met. Similar arrangements are planned for **USA 250 World Stamp Exhibition**. Of course, some attendees will stay at non-show hotels in the other parts of the city and suburbs. And still others will use Airbnb.com or similar to reserve non-traditional accommodations. Room reservations will be handled by a separate contractor hired by the Show.

Government per diem for May 2015 for lodging is \$231, with meals being \$71. The current state sales tax is 6.25%, with the Boston restaurant meal tax being 7%. The hotel tax is 14.45%.

Existing Hotels

There are currently 1671 rooms within ¼ mile of the convention center, with an additional 8,194 within a mile from the show venue. There will be 3,987 rooms within ¼ mile and 12,181 within 1 mile in 2026.

Hotels near the BCEC (within ¼ mile)



Westin Boston Waterfront Hotel (physically connect to the BCEC) – Currently 793 rooms

The show headquarters hotel will be the Westin Boston Waterfront Hotel. This hotel is physically attached the BCEC by enclosed walkway. Currently this hotel has 793 rooms. As part of the BCEC Expansion Project, another 350 rooms will be added to this hotel. Event room rate, as arranged by the BCEC, is \$249 (2015 price with 3%-5% annual escalator).

Three other hotels are within a quarter mile of the convention center. They are the Renaissance Boston Waterfront Hotel (450 rooms – event room rate \$249, 2015 price with 3%-5% annual escalator), the Boston Seaport Hotel (428 rooms – event room rate \$229, 2015 price with 3% annual escalator), and the Residence Inn Boston Downtown/Seaport (120 rooms).



Renaissance Boston Waterfront Hotel – 450 rooms



Seaport Boston Hotel – 428 rooms



Residence Inn Downtown Boston/Seaport – 120 suites

Other Hotels in Downtown (all approximately a mile from the BCEC)

Hilton Boston Downtown – 362 rooms (event room rate \$249, 2015 price with 3% annual escalator)
Hyatt Regency Boston – 500 rooms (event room rate \$259/\$284, 2015 price with 3% annual escalator)
Omni Parker House Hotel – 551 rooms (event room rate \$249, 2015 price with 2% annual escalator)
InterContinental Boston – 424 rooms
The Langham – 318 rooms
Boston Harbor Hotel – 230 rooms

Other Hotels in Back Bay (all approximately a mile from the BCEC)

The Lenox Hotel – 214 rooms
Copley Square Hotel – 143 rooms
Colonnade Boston Hotel – 285 rooms
Westin Copley Place – 803 rooms
Eliot Hotel – 95 rooms
The Midtown Hotel – 159 rooms
Mandarin Oriental – 148 rooms
Sheraton Boston Hotel – 1220 rooms
Hotel 140 – 65 rooms
Boston Common Hotel – 64 rooms
Taj Boston – 273 rooms
Fairmont Copley Plaza – 383 rooms
The Charlesmark at Copley – 40 rooms
Courtyard Boston Copley – 81 rooms
Hilton Boston Back Bay – 385 rooms
Loews Boston Hotel – 225 rooms
Boston Marriott Copley Place – 1148 rooms
Newbury Guest House – 32 rooms
Copley House – 39 rooms
Royalton Suites – 7 rooms

Other Hotels South of Boston (all approximately three miles from the BCEC)

Holiday Inn Express Boston – 118 rooms (event room rate \$229, 2015 price with 4% annual escalator)
Courtyard by Marriott South Boston – 164 rooms (event room rate \$219, 2015 price with 2% annual escalator)
Hampton Inn & Suites Boston Crosstown Center – 175 rooms (event room rate \$229, 2015 price with 3% annual escalator)

Note: These hotels provide free shuttle service to BCEC, free internet, free breakfast.

Hotels Under Construction

As part of the BCEC Expansion two moderately priced hotels, Aloft and Element, are now being constructed. The Aloft will have 330 rooms, while the Element will have 180 rooms. They will be located next to each other, just across the street from the BCEC and next to the Westin Boston Waterfront (show headquarters hotel). The Aloft is scheduled to open in March 2016. The Element is scheduled to open in December 2015.



Sign at construction site

In October 2013 work commenced on the Envoy Hotel, also in Waterfront District. It will have 136 rooms and be part of Marriott's Autograph Collection when it opens in 2015.

A Second Convention Center Hotel

The BCEC Expansion Plan also includes the construction of a second convention center hotel that will be across the street from the front of the BCEC and the Westin Boston Waterfront Hotel and will have 1200 to 1500 rooms. Construction is set to start in 2016, with the opening in 2019.



Excerpts from Massachusetts Convention Partnership • Final Report July 2011 Meeting the 21st Century

Expected Hotel Rooms in 2026

Total adjacent hotel rooms (connected to BCEC or across the street) – 2,853 (793 rooms exist now)

Total adjacent hotel room nights – 22,824 (8 nights X 2,853 rooms)

Total nearby hotel rooms (within ¼ mile of BCEC, but not adjacent) – 1,134 (998 rooms exist now)

Total nearby hotel room nights – 9,072 (8 nights X 1,134 rooms)

Total other hotel rooms (approximately 1 mile from BCEC in Downtown & Back Bay) – 8,194 (exist now)

Total other hotel room nights – 65,552 (8 nights X 8,194 rooms)

Total other hotel rooms (approximately 3 miles from BCEC in south Boston) – 457 (exist now)

Total other hotel room nights – 3,656 (8 nights X 457 rooms)

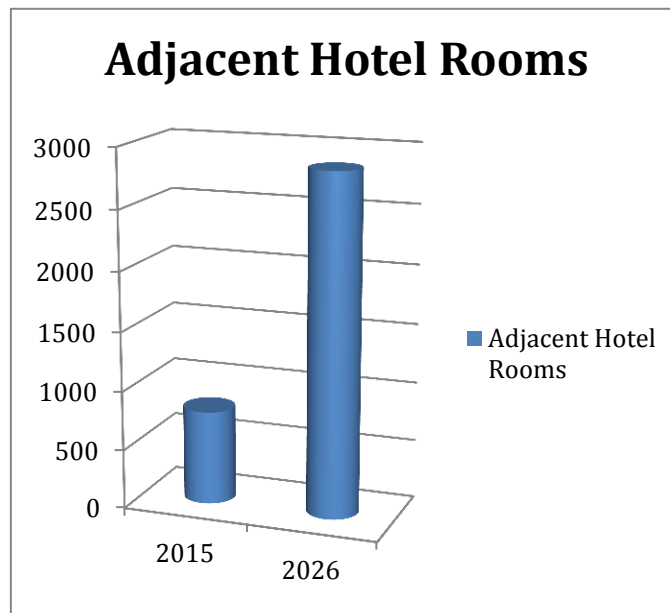

Transportation/Logistics

International Air Access

Logan Airport is one of the 30 busiest airports in the world and the one of the 20 busiest airports in the United States. It is also the 12th busiest United States airport in terms of international traffic with 125 daily non-stop international flights. In 2013 Logan received 15.139 million passengers (41,500 per day). Logan is just 3.4 miles from the BCEC (8 minutes via MBTA Silver Line - \$2.10). This is a very short distance compared with airports in other major cities.



International non-stop service between Logan and the following FIP countries is currently provided by these airlines:

Canada	Air Canada, Porter Airlines
China	Hainan Airlines
France	Air France, Delta, American
Germany	Lufthansa
Hong Kong	Cathay Pacific (starts May 2015)
Iceland	Icelandair
Ireland	Aer Lingus
Italy	Alitalia
Japan	Japan Airlines
Mexico	JetBlue, Delta
Netherlands	Delta, KLM
Portugal	SATA
Spain	Iberia
Switzerland	Swiss International Airlines
Turkey	Turkish Airlines
UAE	Emirates
UK	American, British Airways, Virgin Atlantic, Delta

Non-direct International Air Access

Newark International Airport is directly connected to Amtrak's Northeast Corridor by airport monorail. High speed Acela Express service is available between Newark and Boston South Station (2/3 mile from BCEC). This means that visitors from the following additional countries can fly non-stop to the show via these airlines:

Austria	Austrian
Belgium	United, Jet Airways
Colombia	United
Costa Rica	United
Denmark	SAS, United
Guatemala	United
India	Air India, Jet Airways, United
Israel	El Al, United
Norway	SAS
Poland	LOT
Sweden	SAS, United

Many other countries not directly connected to Logan or Newark, have non-stop or direct service to JFK. In addition, T. F. Greene in Providence, RI offers international service, as does Bradley International Airport in Hartford, CT, and Portland International Jetport in Portland, ME.

Customs

Logan Airport maintains a 24/7 Customs Port of Entry. As current US Customs and Border Protection policies aim to increase the pre-clearance of foreigners abroad (requiring travelers to go through a pre-clearance before boarding aircraft), alternatives to requiring all non-USA commissioners with exhibits to fly non-stop to Logan Airport from a foreign airport are currently under study. Standard references to the changing nature of this aspect can be found at www.cbp.gov/border-security/ports-entry/operations/preclearance. In any event, a customs broker will be hired to facilitate the importation and exportation of exhibits and dealer/post office stock.

Currently, US Customs at Logan can process 2,000 passengers per hour. There are plans to expand some international gates to handle the Airbus A380 (for Emirates) and improve immigration and passport control kiosk capacity. The airport operators are currently discussing future Boston service with El Al, Aeromexico, and Qatar Airways.

National Air Access

All major domestic airlines fly to Logan from most of their primary and secondary hubs. Currently, Logan is a hub for JetBlue and Delta.

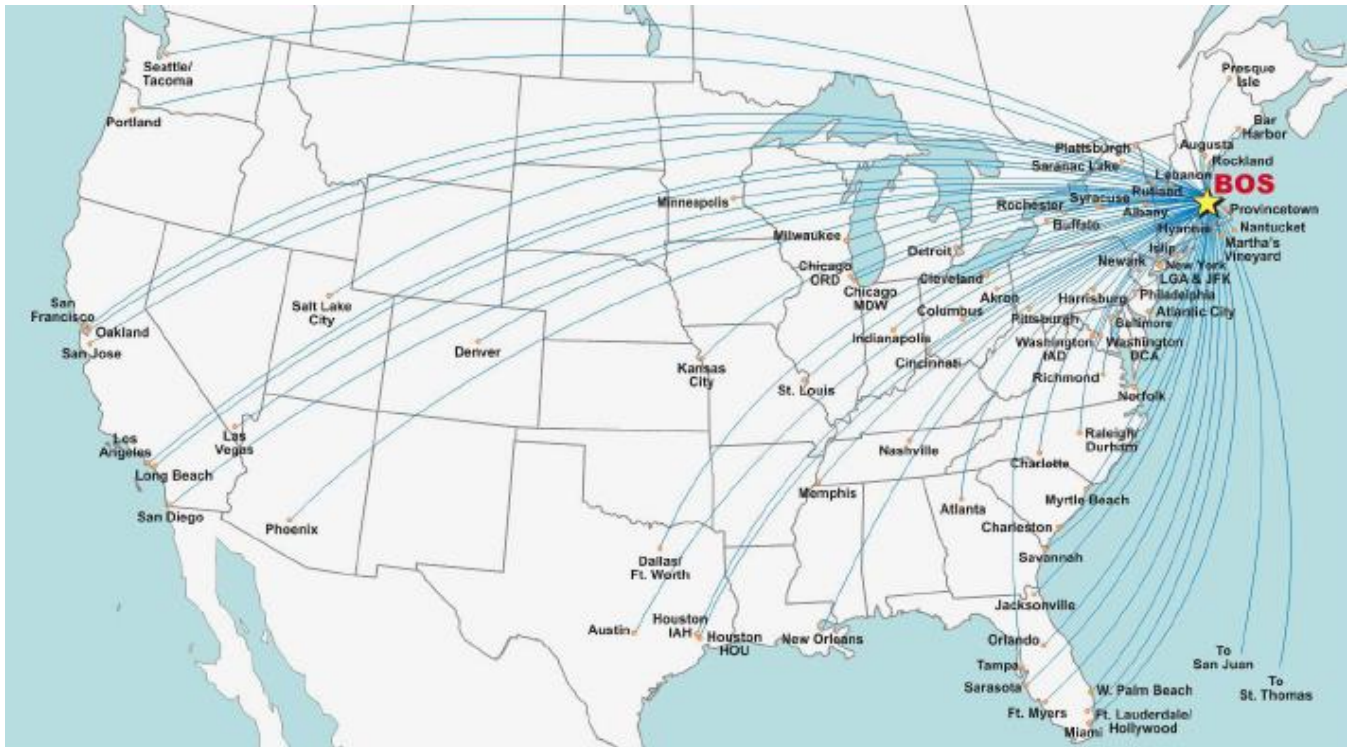

T. F. Green Airport in Providence, RI offers another alternative for domestic flights. T.F. Green is connected to South Station in Boston by MBTA commuter rail line. It is 50 miles driving distance from Boston.

Manchester Regional Airport in Manchester, NH offers yet another alternative for domestic flights. It is 52 highway miles from Boston.

Newark International Airport is directly connected to Amtrak's Northeast Corridor (and South Station in Boston) by airport monorail.

Regional Air Access

Logan Airport is a hub for regional carrier Cape Air. They provide non-stop service to upstate NY, Maine, Vermont, New Hampshire, Cape Cod and Islands.

Regional / National Train Access

Amtrak provides the Acela Express high-speed rail service between Boston's South Station and Washington, DC and points in between. Amtrak also operates the Northeast Regional between South Station and Richmond, VA and the Lake Shore Limited between South Station and Chicago and many points in between.



Acela Route



Amtrak National Routes

Local Train Access

The MBTA operates many commuter rail lines into North and South Station (North Station is connected to South Station by subway) from many points in eastern and central Massachusetts, as well as Providence, Rhode Island. The Old Colony line (not shown) connects South Station to Cape Cod.



MBTA Subway and Bus Access

The Massachusetts Bay Transportation Authority (MBTA) operates a large, multi-line subway within Boston and neighboring communities. South Station is on the Red and Silver Lines and is a 12 minute walk to the BCEC. The World Trade Center on the Silver Line is a 200 yard walk to the BCEC. Attendees from Boston and the surrounding suburbs will be encouraged to take the MBTA subway to the BCEC (current fare: \$2.10).

The MBTA also operates an extensive bus system within Boston and neighboring communities.



Track 61

Track 61 is an unused rail track that connects the Waterfront to Back Bay. Built in the 1850s, it carried freight to a now non-existent rail yard located at the Waterfront. It was last used to carry freight during the Big Dig project in the 1990s and 2000s. Plans are now being developed to convert the line into a passenger service with a station located at the BCEC by 2020.

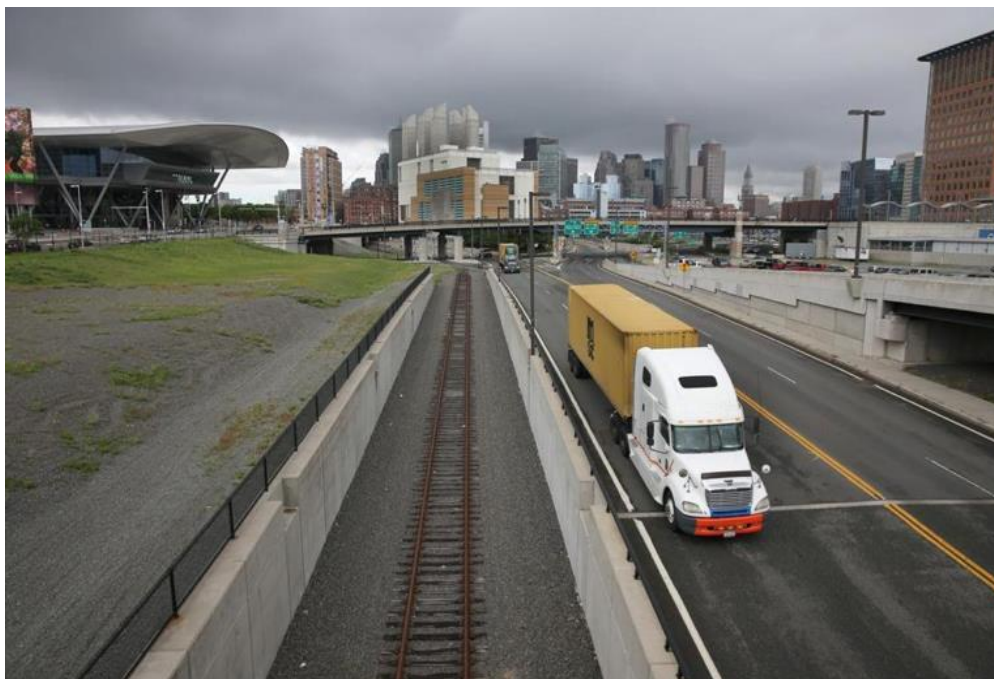
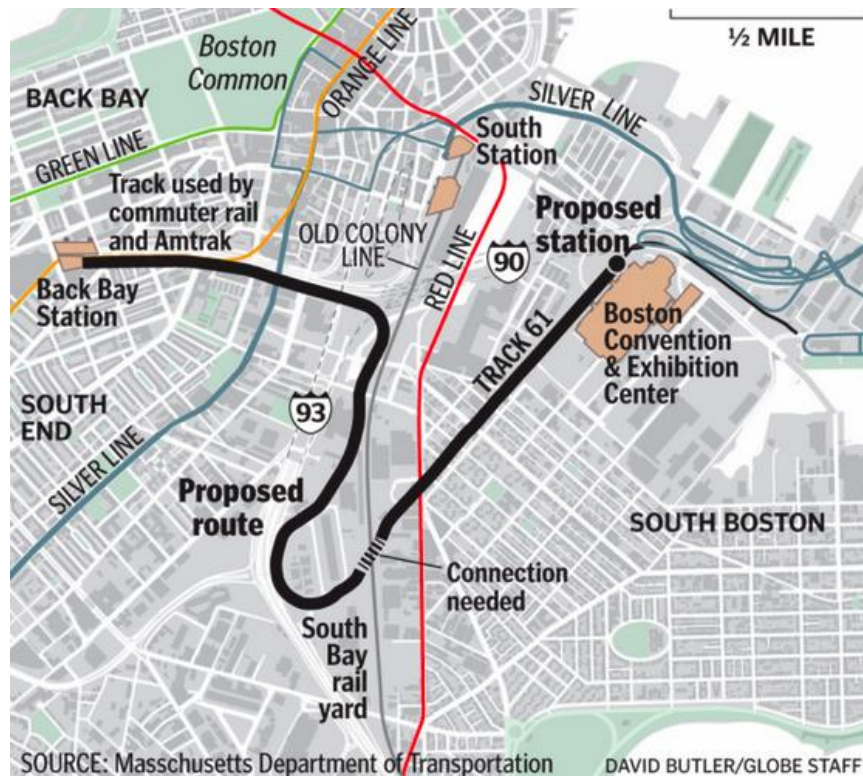

Track 61 in front of BCEC

Inter-City Bus Services

Greyhound and Peter Pan are the major bus services that serve South Station.



Other bus services that go to South Station include: Concord Coach Lines (NH and ME), Dartmouth Coach (NH), Boston Express (Boston suburbs), and Plymouth & Brockton (SE Massachusetts, including Cape Cod).

There are currently three inter-city Chinese (discount) bus services that operate between New York Chinatown and South Station (South Station borders Boston's Chinatown). They are Lucky Star Bus, Yo!Bus, and Go Buses.

Tourist Trolleys

A hop-on, hop-off Tourist Trolley service is available between the Boston waterfront, where the BCEC is located, and some of the most popular sight-seeing locations and tourist attractions in Boston.

Water Taxi

A year round water taxi service is available between Logan Airport and a number of locations in the Boston waterfront.

Ferries

A ferry service is available between Boston and Provincetown, Martha's Vineyard, Salem and other locations.

Zip Cars

This car-sharing service is widely available throughout the city of Boston.

Bicycles

Bicycle rental stands are located in major tourist areas in Boston. They are unmanned and can be quickly accessed with credit cards. Many streets and avenues in Boston and its suburbs have designated bike lanes.

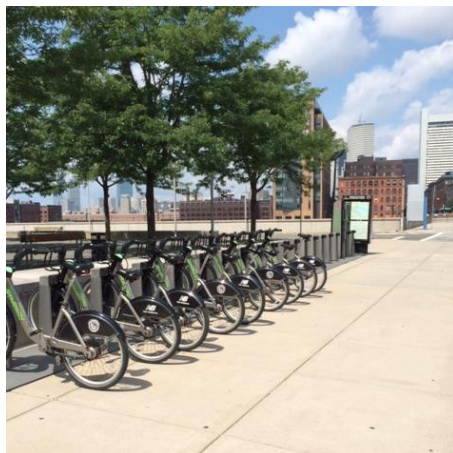

Bicycle Rental Stands in front of BCEC

Driving

The BCEC is directly connected to the Mass Pike (exit 25) and ½ mile from Interstate 93. Note that the Big Dig transportation infrastructure project is now complete.

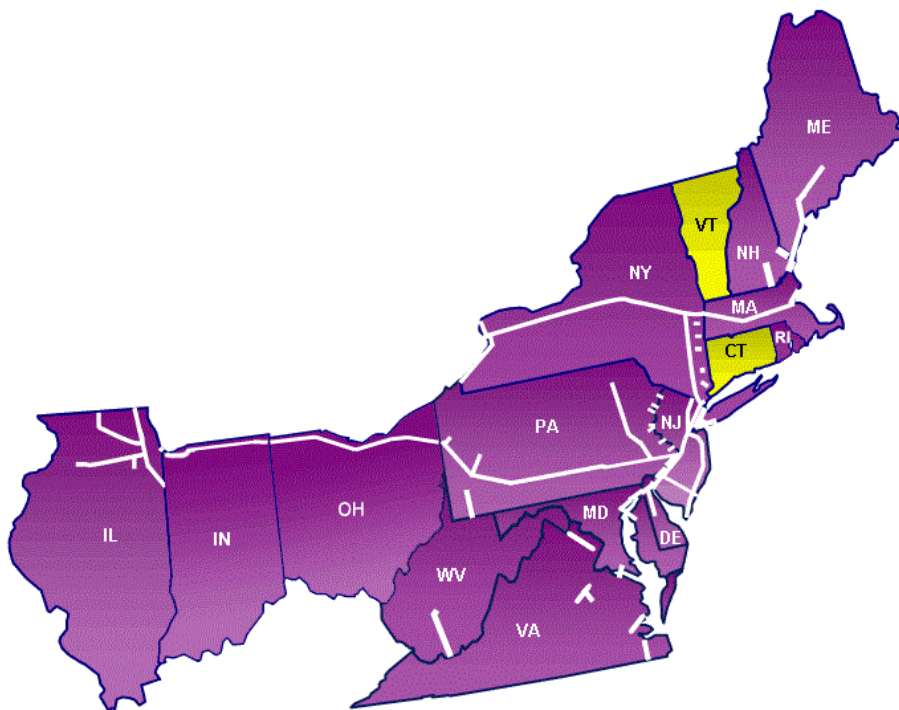
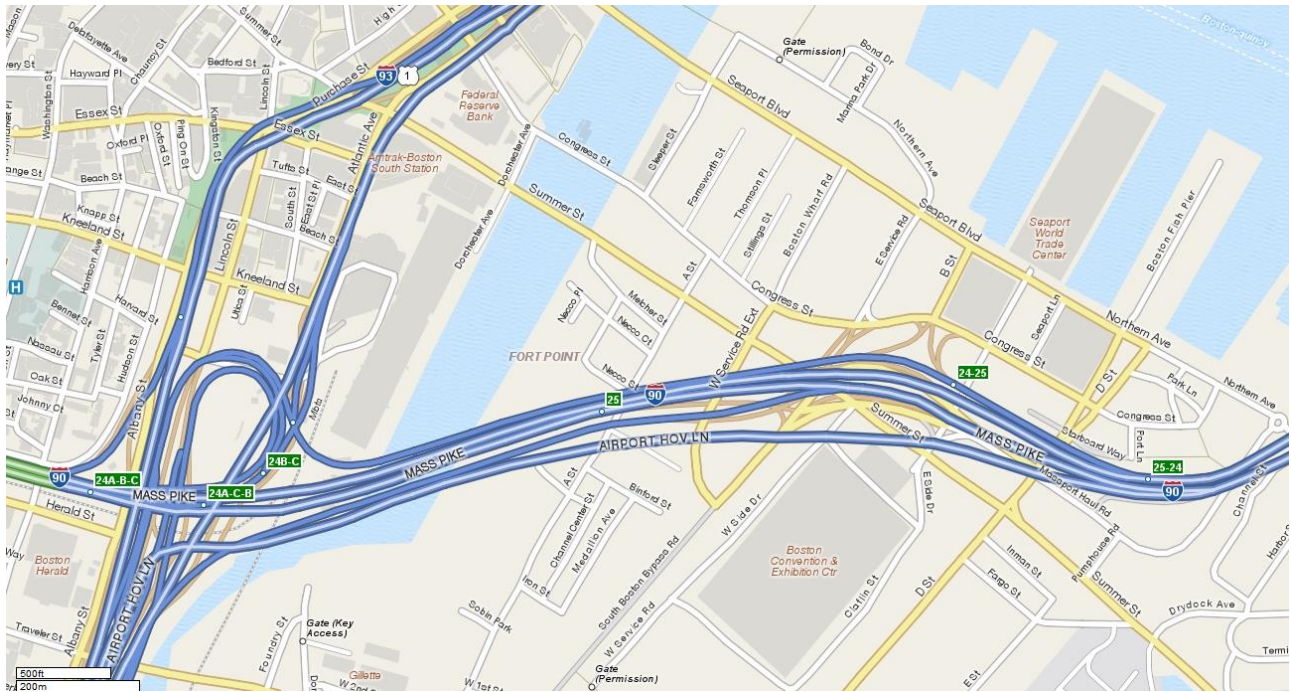

EZ-Pass can be used to pay all Massachusetts tolls. Massachusetts is part of this large toll payment network that covers 14 states (Vermont and Connecticut are non-toll states).



Parking

Currently there are over 10,000 outdoor parking spaces operated by various companies within ½ mile of the BCEC. This includes 1,350 spaces in the existing South Lot of the BCEC. However the South Lot will be converted into the expanded convention area (buildings labeled as BCEC Expansion – below). These lost spaces will be replaced by two new parking garages to be constructed as part of the same expansion project. These garages will contain approximately 2,000 spaces and be located across the street from the BCEC. There are also 200 BCEC valet parking spots. All nearby hotels have their own parking.

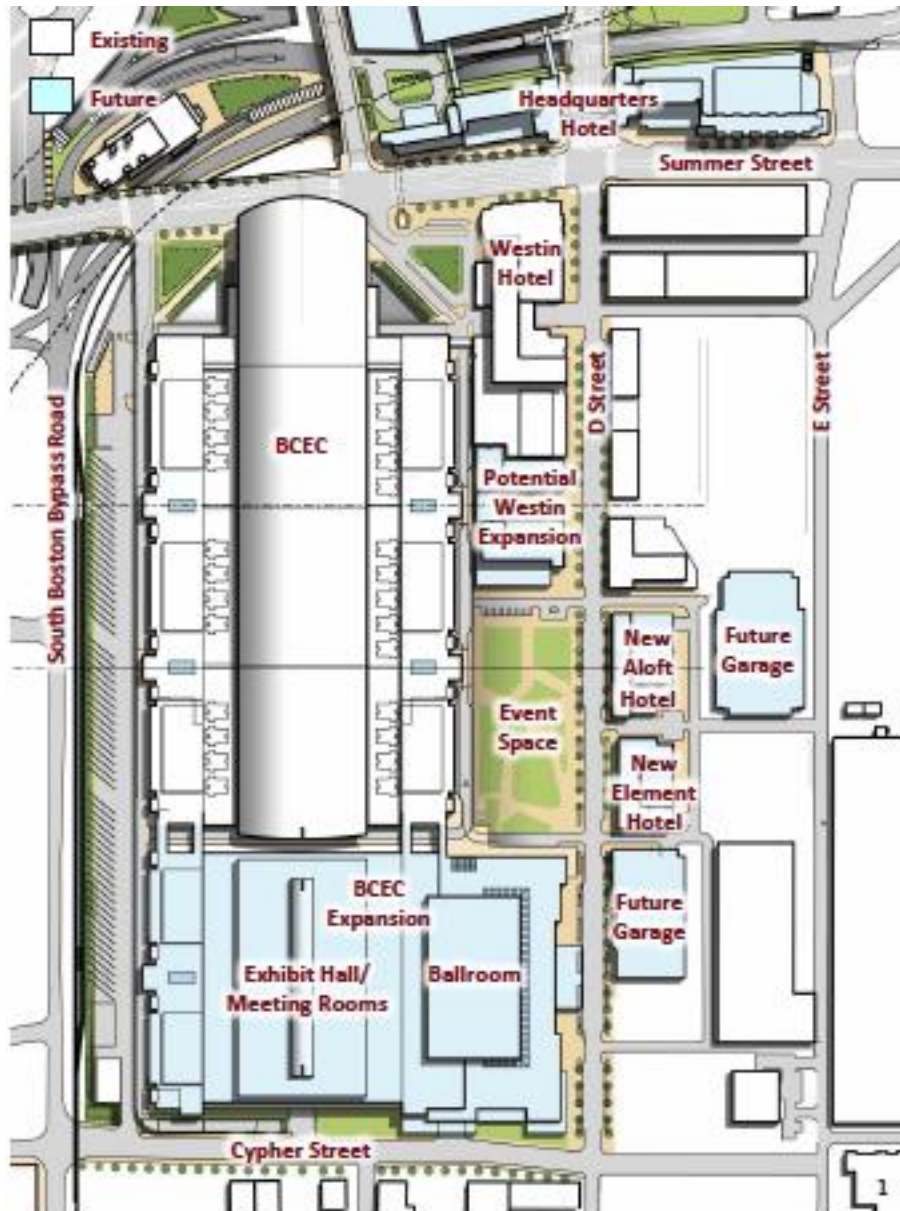

Invitation from Boston Convention Marketing Center



BOSTON. MAKING CONVENTION HISTORY.

February 17, 2012

Mark A. Butterline
Northeastern Federation of Stamp Clubs
C/O Spellman Museum of Stamps & Postal History
235 Wellesley Street at Regis College
Weston, MA 02493

Dear Mr. Butterline,

I am pleased and proud to extend an invitation for Boston to host the World Philatelic Exposition and Conference in May of 2026.

As you know, Boston is a dynamic city steeped in history, culture, and old world charm and cosmopolitan sophistication. Boston belongs to a diversity of people whose heritage is drawn from every corner of the world. They have helped to shape a distinctive city of unique neighborhoods and character without compromising our common heritage. Known nationally as "America's Walking City," Boston has all the amenities of a big city, with the comfort and feel of a small town.

As Executive Director of the Boston Convention Marketing Center, I invite you to share our vitality and take advantage of all that Boston has to offer. Our long and rich history which includes an exceptional selection of world-class hotels, nationally acclaimed restaurants and an extensive transit system make Boston the ideal city for the World Philatelic Expo and its members from all corners of the world.

On behalf of the Boston Hospitality Community, I invite you and your members to come to Boston in 2026. Should Boston be awarded the privilege and distinction to host this meeting, we will be committed to making it your most successful meeting.

Sincerely,

Milt Herbert
Executive Director

BOSTON CONVENTION MARKETING CENTER

415 Summer Street, Boston, Massachusetts 02210 • p: 617.954.2800 f: 617.954.3326 • www.AdvantageBOSTON.com

The Massachusetts Convention Center Authority owns and operates the Boston Convention & Exhibition Center and the John B. Hynes Veterans Memorial Convention Center. The Boston Convention Marketing Center is a joint effort of the Greater Boston Convention & Visitors Bureau and the Massachusetts Convention Center Authority to market and sell the Boston Convention & Exhibition Center and the John B. Hynes Veterans Memorial Convention Center.

Invitation from Boston Mayor



CITY OF BOSTON • MASSACHUSETTS

OFFICE OF THE MAYOR
MARTIN J. WALSH

November 24, 2014

Mark A. Butterline
President
Northeastern Federation of Stamp Clubs
c/o Spellman Museum of Stamps & Postal History
235 Wellesley Street at Regis College
Weston, MA 02493

Dear Mr. Butterline,

On behalf of the City of Boston, I thank you for your consideration of Boston as a host city for the 2026 World Stamp Show.

Boston is one of America's first and oldest cities and offers a mix of historical, educational and cultural sites and opportunities across the city for your members to visit and enjoy. These sites have helped to shape the character of our neighborhoods and they make our city unique. While walking the Freedom Trail or visiting our vibrant neighborhoods, your attendees will enjoy Boston with a personal connection to history & culture that will be cherished for years to come.

Boston offers one of the newest, most technologically advanced convention centers in the United States, the Boston Convention & Exhibition Center, as well as first class hotel accommodations that World Stamp Show members will enjoy. Boston's Northeast location provides easy transportation to the rest of New England and the Eastern United States for your attendee and expo participant base.

As Mayor, I invite you to share our vitality and take advantage of all that Boston has to offer. Stroll the decks of the USS Constitution or the sidewalks of fashionable Newbury Street. Celebrate feast days with the North End's Italian community, explore the historical landmarks on the Freedom Trail or discover unique treasures offered through Boston's National Historic Park Service. Our treasured heritage, exceptional selection of world-class hotels, nationally acclaimed restaurants and extensive transit system make Boston the ideal city for the World Stamp Show in 2026.

Again, thank you for your consideration and attention to this matter. If I may be of any further assistance to you or your staff during the selection process, please do not hesitate to contact me.

Sincerely,

Martin J. Walsh
Mayor of Boston

BOSTON CITY HALL • ONE CITY HALL SQUARE • BOSTON • MASSACHUSETTS • 02201
617-635-4500 • www.boston.gov

PRINTED ON RECYCLED PAPER

SECURE

Convention Center Commitment

The Massachusetts Convention Center Authority (MCCA) has indicated that they do not accept letters of intent for purposes of making a Boston convention reservation. After reviewing the American international philatelic exhibition selection process, the MCCA stated that they would only accept a reservation from the organizers after it had been approved by the American Philatelic Society Board of Directors.

The convention center reservation would be due within 30 to 45 days after APS approval is granted. An initial deposit in the range of \$10,000 would be required at that point. A supplemental deposit that would bring the whole deposit (\$40,000) to 10% of the anticipated BCEC charges would need to be paid by May 2021. A headquarters hotel agreement (no deposit) would also be entered into at the same time as the BCEC reservation.

The initial \$10,000 deposit will be paid by the Northeastern Federation of Stamp Clubs. A combination of early fund raising and 2016 legacy would be used to pay the balance of the deposit.



Exhibit Frames

An international show will require approximately 3,500 exhibit frames. In general, a large number of new frames are procured for each American international, although pre-existing frames that are located in the local or regional area are also utilized. It is estimated that 500 such pre-existing frames would be available for use by **USA 250 World Stamp Exhibition**. Most of these are owned by the NEFSC.

Currently, there is no regular supplier of exhibit frames in the United States. The organizers will need to address this challenge. This may require an offshore supplier. The preliminary budget estimates the cost for 3,000 new frames at \$300,000 (\$100 per frame or \$200 per A-frame unit). A new frame design that improves security and protects philatelic items from light damage, but requires less time to securely and efficiently seal, will be explored. This might involve a variation on the frames produced and used at the recent FIP Malaysia show (shown below).



Another option may be to lease the frames from other national shows. The cost of transportation might be lower than that of obtaining new frames. They could be stored temporarily at the Spellman Museum or a local warehouse. It is also possible that frames from NY 2016 will be available for lease or sale.

Decorator

Referencing past shows' requirements and in consultation with our own engineer, an RFP will be issued for the exhibition hall decorator bids. Large booths for auctioneers or large firms may be created to their specifications using their own decorator and at their own expense.

Security

USA 250 World Stamp Exhibition will have a Security Committee headed by its own chairman. They will be responsible for providing physical and electronic security before, during, and after the show.

Our preliminary budget calls for 25 guards to be present 24/7. These guards would be provided by the BCEC. The BCEC will also provide a security manager. The focus of the guards will be show security and not counting entrances or other unrelated functions.

The Security Committee would be responsible for training the guards on what to look for at a large stamp show. The BCEC security manager will also work with the Boston Police Department to provide armed uniformed policemen in the main exhibition area during the show.

The Security Committee will work with the BCEC and possibly other suppliers to provide the needed electronic surveillance before, during and after the show.

Regarding the handling of cash at the show, **USA 250 World Stamp Exhibition** will establish a banking relationship with the Santander Bank at 200 Seaport Boulevard. This bank branch is approximately 250 yards from the BCEC entrance.

In addition to issues related to security at the show site, **USA 250 World Stamp Exhibition** will utilize facilities of the nearby Spellman Museum (in Weston, MA) to store exhibits before and after the show. This might include the storage of domestic exhibits not carried by USA commissioners directly to the show and/or the post-show storage of exhibits for non-USA commissioners that, for whatever reason, are not returning to their home countries immediately after the show. These exhibits would be stored in dedicated, locked cabinets in the double-door, locked vault in the basement of the Spellman Museum.

Youth and Beginner

Youth and beginner level activities will be available to encourage interactive behavior among attendees newly exposed to the hobby. Those schools still open and homeschoolers will be encouraged to attend with a support for bus monies. Programs and activities will be prepared to engage medium sized classes (25-30), for large group participation (up to 100), and a limited number of small groups (5-10). The Spellman is soon to open a specialized library devoted to tools for introducing youth, enlightening teachers and youth leaders in the practical applications of stamps in classroom, allowing for a solid basis for future endeavors to build upon. The youth outreach and elder hostel/road scholar efforts already available on the Regis College campus and at nearby Bridgewater State University already engage school children and young people in the metro-Boston area. We anticipate involvement from Regis College students, as well as members of our philatelic volunteers and the people who lead the youth area annually at Philatelic Show in Boxborough. The Criminal Offender Record Information (CORI) screening will be administered to all individuals who volunteer to work in the youth and beginner area.

Should we receive the nod, both a Teen Stamp Council and additional **USA 250 World Stamp Exhibition** adult groups will be formed no later than five years out to build a working group which effectively builds upon the current experiential core to assemble a knowledgeable working group with a youthful outlook and sufficient young bodies to get the job done. The Spellman is well placed to involve both college and religious groups in this endeavor.

Related Meetings and Conventions

Upon acceptance of this bid by the APS Board of Directors, the organizers will reach out to other postal and philatelic organizations to gauge their interest in staging concurrent meetings or conventions in conjunction with **USA 250 World Stamp Exhibition** under the auspices of the APS and the USPS. These organizations include, but are not limited to: UPU, FIP, FIAF, ASCAT, National Postal Forum, USPS departmental conventions, and postal unions. The purpose of this would be to increase the participation of their constituent members and individuals at the show (e.g., we would look for a concurrent UPU Congress to increase the participation level of foreign post offices at the show).



Note that the long lead-time for large conventions means that this work would commence almost immediately after the acceptance of this bid. Of course these concurrent assemblies would have to pay their own costs, although the show might provide free meeting space for an FIP Congress or ASCAT meeting.

FIP Centenary

Note also that 2026 will mark the 100th anniversary of the establishment of the FIP. We expect that a centenary Congress and a gala celebration (black-tie banquet) would be held somewhere in the world during that year. According to Article 20.1 of the FIP Statutes the Congress shall meet every second year at the time and place determined by the preceding Congress. The organizers hope to have these events held in conjunction with **USA 250 World Stamp Exhibition**. While there are significant expenses and responsibilities to hosting a FIP Congress, having the show stage the gala could be a significant profit making opportunity.



Weather

On average, Boston experiences very pleasant weather at the end of May. The average high temperature on May 23 (opening day) is 68°, with an average low temperature of 52°. The average high temperature on May 30 (closing day) is 71°, with an average low temperature of 54°. Average precipitation is 0.13 inches per day.

Music and Art

Music and art will also be part of the **USA 250 World Stamp Exhibition** experience. There will be a stage for musical performances on the exhibition floor (live and DJ). Some presentations will have a postal theme, while some others will have a colonial/revolutionary theme.

An appropriate art installation (philatelic related), possibly organized in conjunction with the nearby Institute of Contemporary Art (ICA), will be investigated. Cultural awareness partnerships with the Museum of Fine Arts (MFA), Children's Science Museum and the Boston Symphony Orchestra (BSO) will be encouraged.



Finances

If our bid is approved, the organizing committee will immediately move to establish a 501(c)(3) non-profit educational corporation. We will also obtain a Massachusetts state tax exemption certificate.

A discussion of important financial issues and a preliminary budget follows.

Convention Center

The BCEC has provided an initial estimate of their charges. The cost for the exhibition space (Exhibit Halls A & B – 354,000 sq ft), plus 42 meeting rooms (various sizes) and a banquet room (palmares dinner and opening ceremonies) is \$399,000 (nominal dollars). The main factors in determining the charges for BCEC exhibition and meeting space, beyond the obvious (i.e., amount of exhibition floor space and size/number of meeting rooms), are projected number of hotel rooms (a single hotel contract will be required – presumably the Westin Waterfront as our headquarters hotel) and projected BCEC food & beverage charges (\$190,000 requirement – 40c/\$1 penalty for any shortfall). Lesser factors include staging the show during a holiday week, as well as taking a “floating” reservation for the exhibition floor space at the BCEC (i.e., the BCEC would guarantee a certain amount of contiguous exhibition floor space, but would only confirm the specific halls to be used a few years before the show).

The BCEC will also handle our hotel negotiations. This means we will receive commissions of \$10/room-night when attendees stay at official show hotels. These commissions would be applied to our BCEC charges.

Sponsorships

USPS sponsorship will be an important source of support for the show. Significant effort will be made to ensure their early and extensive involvement, including philatelic emissions commemorating 250th anniversary events. No other city or region has more stamp issuing possibilities than Boston and New England. For the United States Bicentennial over 50 stamps were issued by the USPS. In addition, a large number of foreign postal administrations issued bicentennial commemoratives. There will likely be a similar number of emissions for the 250th anniversary.

An important part of USPS involvement (maybe the most important from a political point of view for this very-high profile public company) is their ability to make a profit at the show. The USPS made a small profit at Washington 2006. The organizing committee feels that USPS show profits need to be much more aggressively pursued.

Other, local but non-philatelic, sponsorships will be pursued the team. Additional business (including Carter’s Ink Company, John Hancock, American Graphics Institute, Legal Seafood, Harpoon Brewery), electronic (such as Google, eBay) and genealogical (such as Ancestry.com and Massachusetts-Genealogy.com) funding and partnership opportunities are under discussion. Collaborative efforts are essential to bring the celebration of the country’s 250th anniversary to realization.

Dealer Bourse

The dealer bourse will be the main source of funding and we have several active dealers already on our Support Team. There will be approximately 200 booths. The organizers anticipate that the nature of the philatelic trade will change significantly in the next decade. American stamp dealers are aging and there does not seem to be a large pool of younger dealers to replace them. It may be difficult to sell all 200 dealer tables planned for the show to this group.

We plan to mount an aggressive dealer-to-dealer marketing campaign as well as an early pre-sale pricing scale to bring in as many hard-table dealers as possible. We are exploring an initiative to bring in as many Internet-based and foreign dealers as possible.

Another alternative could be to have sections of dealers of other collectible items such as coins, paper ephemera, postcards, antiquarian books, etc. There are already regional, national and international meetings of these societies that hold their conventions regularly in the Boston/New England area. We will approach these groups to see if they would consider having their trade show at the BCEC simultaneously with **USA 250 World Stamp Exhibition**. This could help finance the show, increase the public's attendance, and expose a number of serious collectors of other items to many premier philatelic exhibits in the world. There are also many philatelists who collect and exhibit such items (Post Card and Display exhibit classes).

Yet another alternative would involve a reassessment of dealer booth sizes (i.e., significantly increasing the size of the standard dealer booth). While the number of domestic dealers may decline, the current trend of dealers requesting more space at major stamp shows appears to be increasing. The large floor space offered at the Boston's convention center would facilitate such requests.

Postal Administration Booths

Foreign postal administrations will have a significant presence at the show. The organizing committee will work closely with the USPS and UPU to generate a large turnout. This will include the encouragement of an early out-reach by the USPS to foreign post offices to take booths, as well as a very early out-reach to the UPU for a possible concurrent congress or other significant meeting. If this happens, postal administration booths could be priced more aggressively than they have been in the past.

Admissions

There are no plans to charge for admission. Although the organizers might consider a free Ameripex admission style offering (i.e., at Ameripex there was a fee, but it was essentially non-existent due to pre-printed-admission covers on booklets of stamps printed prior to the show).

VIP Lounge/VIP Exhibit Club

A VIP lounge will be constructed on the exhibition floor with free access provided to significant donors and friends of the show, as well as others who pay an admission fee.

We might also have a VIP Exhibit Club in which the participants pay an amount to be specified to show one or more special items in a special set of frames, apart from the open competition. There could be an accompanying publication about these items.

Souvenirs

Souvenir sales were not a major contributor to Washington 2006 revenues. Visitors, especially those that have traveled long distances and spend many days at the show, will be very interested in procuring such souvenirs to commemorate their visit to **USA 250 World Stamp Exhibition**, Boston, New England, and the United States. The organizing committee feels that this revenue opportunity needs to be aggressively pursued, not only with local materials but also with philatelic items, such as philatelic engraved souvenir cards as was done at Washington 2006.

Focusing on our theme, it would be appropriate to have a collection of the 1760s stamps issued that caused the Revolution and the Boston Tea Party under the Stamp Act, perhaps with reproductions as souvenirs.

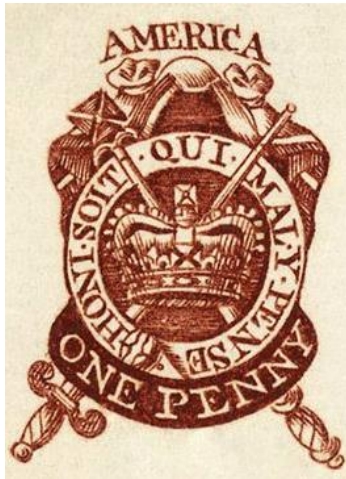

Stamp from Tax Act of 1765 to raise funds
for the French and Indian War

International Marketing & Technology

As technology in 2026 will make it much easier for non-English speakers to visit and enjoy the show (using body-based translation devices, both audio and visual), the organizers plan a more aggressive international marketing plan than previous shows.

Donations

The organizers will plan and launch an aggressive fund raising effort. This will be directed by a professional fund raiser, Suzanne Kouri.

Financial Reporting

After incorporation, quarterly financial reports would be generated and transmitted to the APS. Starting about 2023, annual financial reports would be audited and published.

Preliminary Budget

Preliminary estimated income in 2015 dollars:

Admissions (50,000)	\$0	\$0 at W2006
Dealer (200) & Postal Administration Booths (65)	\$2,000,000	\$1,813,134 at W2006
USPS Area	\$500,000	\$935,853 at W2006
Society Booths (60)	\$30,000	\$45,535 at W2006
Frame Fees (3,500 frames X \$125/frame)	\$435,000	\$214,417 at W2006
Literature Entry Fees (200 X \$125/entry)	\$25,000	
Hotel Commissions (\$10/rm-night X 10,000 rm-nights)	\$100,000	
Advertising (website & publications)	\$50,000	\$64,806 at W2006
Donations (including seed money from previous international show)	\$1,000,000	\$370,012 at W2006 \$625,000+ at NY2016
Catalogue Sales (3,500 paid X \$30)	\$105,000	\$96,439 at W2006
Auction Fees	\$75,000	\$51,500 at W2006
Souvenir Sales (passports, show medals, gifts)	\$100,000	\$41,978 at W2006
Palmares Dinner (500 paid X \$250/attendee)	\$125,000	
VIP Lounge Memberships (100 X \$200)	\$20,000	\$5,250 at W2006
Interest	\$10,000	\$67,595 at W2006
Total Estimated Receipts	\$4,575,000	\$3,849,217 at W2006

Preliminary estimated expenses in 2015 dollars:

Convention Center (exhibit floor, meeting rooms)	\$399,000	\$356,245 at W2006 \$399,000 is in 2026 dollars
Frames (3,000 X \$100/frame)	\$300,000	\$108,760 at W2006
Decorators (booths, signage, rigging, etc.)	\$1,000,000	\$1,156,179 at W2006
Printing (bulletins, catalogues, palmares, etc.)	\$200,000	\$120,797 at W2006
Medals (awards, souvenirs) & Other Awards	\$150,000	\$94,192 at W2006
Advertising	\$300,000	\$284,938 at W2006
Advance Promotion (at WSP shows)	\$50,000	\$99,247 for all promotion at W2006
Advance Promotion (at International shows)	\$200,000	
Palmares Dinner (750 attendees X \$125/attendee)	\$95,000	
Insurance (\$5M)	\$100,000	\$83,197 at W2006
Administration	\$500,000	
Security (25 guards X 24/7) & Police	\$200,000	\$283,959 at W2006
FIP Patronage Fee (66,000 CHF)	\$50,000	\$36,248 at W2006
FIP Congress Costs	\$20,000	
Hospitality/Receptions/Outings	\$100,000	
AV for Meetings	\$35,000	
VIP Lounge	\$30,000	
Youth/Beginner	\$100,000	\$55,657 at W2006
Jury (40 – coach airfare, hotel, small per diem)	\$200,000	\$187,483 at W2006
Commissioners (80 – hotel, small per diem)	\$160,000	\$161,498 at W2006
Surplus	\$386,000	\$349,413 at W2006
Total Estimated Expenses	\$4,575,000	\$3,499,803 at W2006

USA 250 World Stamp Exhibition Organization

Key philatelic leaders were approached to take principal executive rolls in a 2026 venture should the project become actively pursued. Among those recruited for key roles are:

President – Dr. Yamil Kouri
Vice President – Nancy Clark
Chief Financial Officer – Steve Walske
Executive Director – Mark A. Butterline
Secretary – Christopher Brouady
General Counsel – George Norton

International Show Consultants include Charles J. G. Verge, Michael Dixon and Gordon C. Morison.

Support Team recruitment has begun. Among those recruited are Omar Rodriguez, Tim O'Connor, Bill Schultz, Mike Mead, Larry Fillion, Tony Dewey, Stephen Taylor, Joan Stanley, Steve Zirinsky, Alex Hall, Jeff Shapiro, Doug Clark, Mark Schwartz, Norm Shufrin, Michael Dixon, Alan Barasch, Suzanne Kouri and Joe Mullen. In addition, the Spellman Museum of Stamps & Postal History is on board as a supporter.

While we are well aware that attrition through health and death will doubtless make for changes in the specified positions, there is a depth of valuable, experience and talent in the New England philatelic community from which to draw. A great deal can happen over eleven years. Therefore a clear succession plan allowing for newer members of the leadership and volunteer ranks to be tapped will be spelled out within three months after a successful bid.

Volunteers

We will recruit volunteers locally, regionally and from across the country, with a few key players from other countries. They will be recruited by individual team leaders, who will select experienced people in their area of guidance, and through electronic/technological means. Volunteer support facilities will be made available. This will include the safe storage of bags and purses, as well as a messaging system, based on current technology.

Volunteers, based on the hours they work, will receive recompense in the form of a substantial discount at food stands and various souvenirs. Their assignments and recruitment will be coordinated through a committee head yet to be selected.

Letters of Support

Letters of support from a variety of philatelic organizations are contained in Appendix A.

Geographical Distribution of Philatelic Shows in the United States

The APS philosophy over the last couple of decades has been to rotate the locations of major national philatelic exhibitions to cover as many parts of the country as possible. Although that has traditionally applied to annual shows such as StampShow and AmeriStampExpo, we believe that it should also be extended to international exhibitions. Since 1966, the once-in-a-decade international exhibitions have rotated through different cities, with the only repeating location being Washington, DC (1966 and 2006). Boston's collectors deserve an opportunity to prove how passionate they are about philately and host the next world stamp exposition.

Appendix A – Letters of Support

Athens Philatelic Society

Dec. 27, 2014

Mr. Mark Butterline, President
Northeast Federation of Stamp Clubs
6 Carbone Circle
Maynard, MA 01754

Dear Mr. Butterline:

Given their national and international work in philately, I'm sure you know or have heard of Doug and Nancy Clark. Both were active for a number of years in my club—the Athens Philatelic Society—in Athens, Georgia, and in 1990 I worked with her and Doug in the formation of the Georgia Federation of Stamp Clubs (which ten years ago expanded to become the Southeast Federation of Stamp Clubs). In 1996, Nancy chaired Olympilex 96 (the international stamp show associated with the 1996 Atlanta Olympics), and I again had a chance to work with her—this time for sixteen consecutive days. After Doug's retirement from the University of Georgia, the Clarks moved to Marston Mills, Massachusetts—though they both remain active in our federation's annual Southeastern Stamp Expo

I give this background of my lengthy experience with Nancy and knowledge of her contributions to philately from club to highest levels, and to indicate how much respect I have for her experience in organizing and judging in national and international stamp shows.

As you probably know, Nancy is very eager for Boston to be seriously considered to host the proposed 2026 world exhibition and has asked if the Athens Philatelic Society would endorse this choice. I told her I would take the issue before the club, but first I wanted to hear *why* Boston should get the nod. She made a compelling case. First, the Boston area has a rich philatelic tradition, with considerable experience in running regional and national shows. Second, The Boston area not only enjoys a major reservoir of philatelic knowledge but also has over thirty stamp clubs to provide volunteers to help organize and conduct the show. Third, more than adequate exhibition space for an international show is now available in a centrally situated location, complemented by a new and nationally recognized transportation system. Fourth, the Spellman Museum of Stamps and Postal History and other downtown or nearby cultural attractions, historical sites, and outstanding dining opportunities would attract not only philatelists but their families. This is especially important since, I am told, one in four APS members lives in the Northeast. Nancy has suggested other compelling reasons, but there is also one of equity—Boston has never been afforded the opportunity to host an international philatelic exhibition. Many of the seeds of the American Revolution were sown in the Boston area, and celebration of this nation's 250th birthday would be a fitting occasion for the 2026 world exhibition.

I brought Nancy's request before the Athens Philatelic Society, and the club unanimously voted to support any initiative to secure the exhibition for Boston. At our federation's 2015 Southeastern Stamp Expo in four weeks, I'll be glad to bring the matter up at our

annual meeting—but I feel confident that Southeastern member clubs will follow our endorsement.

Good luck in your efforts, as you certainly seem to have a persuasive case for Boston as host of the 2026 international show.

Sincerely,

A handwritten signature in dark ink, appearing to read 'Ed Jackson', with a long horizontal flourish extending to the right.

Ed Jackson
Athens Philatelic Society (1989-present)
Board of Directors, Southeast Federation of Stamp Clubs (1990-present)
Organizing Committee, Southeast Stamp Expo (1990-present)

Contact Information:

Ed Jackson
127 Riverbottom Circle
Athens GA 30606
edjack@uga.edu

Cape Cod Area Philatelic Group

James Patrick Mauney

October 25, 2014

Mark A. Butterline, President
New England Federation of Stamp Clubs
6 Carbone Circle
Maynard, MA 01754

Dear Mark:

I write on behalf of the Cape Cod Area Philatelic Group to support you and the New England Federation of Stamp Clubs in your efforts to bring to Boston the world stamp show in 2026. Although 2026 seems a long way away, and the New York 2016 show has not yet taken place, we know that planning for such a major event can never begin too soon—particularly the selection of the host city.

Please let me know how the CCAPG can help you and NEFSC in bringing to fruition this exciting project.

Sincerely yours,

Patrick Mauney
President
Cape Cod Area Philatelic Group

P.O. Box 1236, Sagamore Beach, Massachusetts 02562

CHELMSFORD STAMP CLUB

*27 BRENTWOOD RD.
CHELMSFORD, MA 01824
978-256-2256*

November 17, 2014

Dear Sirs & Madams,

The Chelmsford Stamp Club is very happy to support the Northeast Federation of Stamp Clubs in their bid to host the World Stamp Expo 2026.

We realize the planning of such a big even takes years to complete and the first step is in choosing a host city.

Boston, Massachusetts will be an ideal location for the show. It is easily accessible by plane, train, ship and automobile. There are ample hotel accommodations, good public transportation within the city and wonderful places to go sightseeing with museums, parks and historical sights both in the city and a short distance away.

Please know, the Chelmsford Stamp Club will assist in any way required if you select Boston for the 2026 show.

Best regards,



Linda Gilmore
Chelmsford Stamp Club
Treasurer

Fall River Philatelic Society

November 17, 2014

Mark A. Butterline, President
New England Federation of Stamp Clubs
6 Carbone Circle
Maynard, Ma 01754

Dear Mark,

The Fall River Philatelic Society sends their total support to you and the New England Federation of Stamp Clubs regarding your effort to bring the World Stamp Show to the great city of Boston in 2026.

It would be an honor to assist you in any possible way to make this event a reality and success.

Sincerely,

Paula M. Shaker, President

Massachusetts Postal Research Society



MASSACHUSETTS POSTAL RESEARCH SOCIETY

POST OFFICE BOX 427 * MARSTONS MILLS, MA 02648

January 4, 1915

Mark A. Butterline, President
NEFSC
9 Carbone Circle
Maynard, MA 01754

Dear Mark,

For researchers and amateur historians, the Bay state offers a long history and broad range of philatelic artifacts stretching from early colonial times to the present day. The core of the society is based on preserving and recording a history of the post offices in the state, organized by county.

With that background, the Massachusetts Postal Research Society anticipates an active involvement in supporting the efforts of creating this new chapter in the postal history of the Bay State with Boston's winning of the bid for USA 250.

Sincerely,

A handwritten signature in cursive script that reads "Douglas N. Clark".

Douglas N. Clark, President
Massachusetts Postal Research Society

Mobile Post Office Society

AFFILIATE NO. 64, AMERICAN PHILATELIC SOCIETY

Mobile Post Office Society - P. O. Box 427 - Marston Mills, MA 02648

Mark A. Butterline, President
Northeastern Federation of Stamp Clubs
6 Carbone Circle
Maynard, MA 01754

Dear Mr. Butterline,

The Mobile Post Office Society is aware of the proposed bid which the Northeastern Federation of Stamp Clubs is preparing for the FIP show to be hosted by the United States in 2026. As an international society, we would like to offer our support for this bid.

Those of our membership on foreign soil will appreciate the opportunity to visit a city which has been served by trains, buses, trolleys and ships, all of which carried Railway Mail Service personnel, sorting and postmarking mail as it travelled to, from and through your fair city. Those of us who are more local will offer our services in whatever manner we can be fruitfully used to promote philately on an international scale.

We hope you will consider having a refurbished trolley mail car, highway post office or railway mail service car available nearby the Boston Convention Center for your many visitors.

With all best wishes for an excellent exhibition,

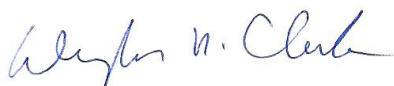

Douglas N. Clark, President
Mobile Post Office Society

The Philatelic Group of Boston

The Philatelic Group of Boston

Founded in 1930

January 5, 2014

Mr. Mark A. Butterline
Northeastern Federation of Stamp Clubs
6 Carbone Circle
Maynard, MA 01754

Dear Mr. Butterline:

The Philatelic Group of Boston strongly supports the proposal submitted by the Northeastern Federation of Stamp Clubs to stage the 2026 International Philatelic Show in Boston. The Philatelic Group was founded in 1930. Its members were instrumental in establishing the Northeastern Federation of Stamp Clubs and have actively served in major leadership and volunteer positions in local, regional, and national philatelic organizations. Philatelic Group members have also played major roles in organizing and staffing highly successful and popular philatelic shows in the northeast. Its members also have extensive knowledge and experience in exhibiting and judging on local, national, and international levels.

The members of The Philatelic Group of Boston will be available to support the USA 250 World Stamp Exhibition and show committee to insure a successful and most memorable philatelic event.

Very truly yours,

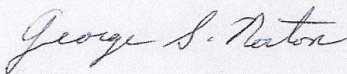

George S. Norton
President
The Philatelic Group of Boston

Rhode Island Philatelic Society



Rhode Island Philatelic Society

PO Box 40665

Providence, Rhode Island 02940-0665

Mark A. Butterline, President
Northeast Federation of Stamp Clubs
6 Carbone Circle
Maynard, MA 01754

December 1, 2014

Dear Mark,

It is with unbridled enthusiasm that the Rhode Island Philatelic Society, the oldest philatelic society in the United States, wholeheartedly supports the bid of the Northeast Federation of Stamp Clubs to bring the stamps collectors of the world to Boston, Massachusetts in 2026.

It is certainly a happy coincidence that the year 2026 also is the 250th anniversary of the Declaration of Independence and what better place to hold the twelfth international philatelic exhibition than in a city that was the birthplace of the American Revolution. Some of the most iconic events in the birth of this nation, the Battle of Lexington and Concord, the Boston Tea Party and the midnight ride of Paul Revere were all milestones on the road to liberty.

As you know the city of Boston is a world class destination. With Logan Airport as the premier gateway to the region and the Boston Convention and Exhibition Center with its half a million square feet as its centerpiece, along with wonderful restaurants, exciting tourist attractions and all within walking distance or a short subway ride the city of Boston will offer visitors a never to be forgotten experience.

Finally, it should be remembered that the Interphil exhibition in Philadelphia in 1976 was not only a celebration of the Bicentennial but it also coincided with the 200th anniversary of the creation of the Postal Service by native Bostonian Benjamin Franklin; the oldest post office in the United States was established in Boston in 1639.

All the members of the Rhode Island Philatelic Society wish you and the NEFSC the best of luck.

Sincerely,

Michael S. Imbruglia
President, Rhode Island Philatelic Society

Rochester Philatelic Association



Rpa

ROCHESTER PHILATELIC ASSOCIATION INC.
POST OFFICE BOX 10206
BRIGHTON STATION
ROCHESTER NY 14610-0206

11/09/14

Sirs,

It is with great pleasure that the members of the Rochester Philatelic Association endorse the Boston bid for hosting the 2026 U.S. international philatelic exhibition.

Of course this would be the first U.S. international that the historic city of Boston will have hosted. The timing couldn't be better, as our nation celebrates its 250th birthday that year. The entire region will be at its finest with year-long celebrations honoring the occasion.

Boston's Logan Airport offers domestic and international flights accessible from everywhere. The city's transportation infrastructure provides visitors easy access to and from the nearby Boston Convention and Exhibition Center, conveniently located in the center of town and on the waterfront. Attractions include the Old North Church, the USS Constitution, the Museum of Fine Arts, Fenway Park, and much more.

Demographically the highest concentration of U.S. philatelists can be found in the northeast and are within a day's drive, train ride or commuter flight from Boston. What a great destination for philatelists and their families! Don't forget the Spellman Museum of Stamps & Postal History in Weston. And unlike many other major cities, it's an affordable option for budget-minded travelers.

On a personal note, our ties with one of the Boston leaders, Nancy Clark, goes back decades when she was a member of our group for many years. Her exceptional leadership with us at that time eventually led her to greater opportunities in philatelic circles nationally and internationally. Besides countless positions with the APS, she most notably chaired the highly successful 1996 Olymphillex'96 Exhibition in conjunction with the Centennial Olympic Games.

We know many other Boston area collectors, exhibitors and dealers, including Mark Butterline, Mike Mead, Guy Dillaway and Jeff Shapiro. All are very active, capable and dedicated philatelists bringing a wealth of experience and expertise to the organizing committee.

All in all, Boston offers the "complete package" necessary for a successful U.S. international and worthy of the American Philatelic Society's consideration.

Thomas M. Fortunato
RPA Immediate Past President

Southeastern Stamp Expo

2013-14 Officers:

Charles J. O'Brien, III
President

Thomas Broadhead
Vice President

C. S. Rejent
Treasurer

Gene Zhiiss
Secretary

Scott Mark
Show Chairman

Southeast Federation of Stamp Clubs, Inc.

Furthering philatelic appreciation in the Southeast since 1991

Sponsor of the annual Southeastern Stamp Expo

Member of the American Philatelic Society, #C 164386

Mark Butterline
President, NEFSC
6 Carbone Circle
Maynard, MA
01754

Dear Mr. Butterline:

On behalf of the Organizing Committee of the Southeastern Stamp Expo, it is my honor and privilege to endorse the work of the 2026 Boston World Stamp Expo team, and enthusiastically support the city of Boston for this International Stamp Show.

As show chair since 2005, I have been honored to lead a team that includes nationally celebrated philatelic exhibitors like Charles O'Brien III, Bruce Roberts, Thomas Broadhead, Douglas and Nancy Clark, and John Burnett. Our greater team must have in excess of 100 years of stamp show management experience, many of whom have been managing the Southeastern Stamp Expo since 2000. We are unanimous in our support of the Boston bid, and we base our endorsement upon a demonstrated competence of the management of stamp shows throughout New England.

The City of Boston is a natural backdrop for this international stamp show, particularly in light of the 250th anniversary of American independence. I am unaware that Boston has hosted an international show before, and it is one of the few major cities in the United States that has not. Furthermore, the proximity of the Spellman Museum, the modern venue, and the short ride to the airport lend significant attributes to the show that will benefit attendees and exhibitors.

The team on the ground, with contributions from 30 stamp clubs, is very experienced, having managed Philatelic Show for many years, and having supported the effort to manage and staff the APS StampShow multiple times, including Hartford and Providence. AmeriCover has also been held several times in New England very successfully. There is no shortage of talented and experienced management expertise to execute an international show. I can personally vouch for the skills of Doug and Nancy

Clark. Both Doug and Nancy provide me with valuable counsel as I manage the Atlanta based show, and Nancy's experience managing the youth area at Washington 2006 and her experience as APS Treasurer will go a long way toward assisting the team.

Good luck on your efforts to secure this international stamp show for the city of Boston, and the entire New England philatelic community. Ten years is a long time, but I would imagine that a large contingent of collectors from the Southeastern US will be traveling to Boston, the same way they did to support Washington 2006.

Regards,

A handwritten signature in blue ink that reads "Scott Mark". The signature is written in a cursive style with a long, sweeping underline.

Scott Mark
Chair, Southeastern Stamp Expo 2015

Spellman Museum of Stamps and Postal History



241 WELLESLEY STREET
AT REGIS COLLEGE
WESTON, MA 02493
781-768-8367
www.spellman.org

January 5, 2014

Mr. Mark A. Butterline
Northeastern Federation of Stamp Clubs
6 Carbone Circle
Maynard, MA 01754

Dear Mr. Butterline:

The Spellman Museum of Stamps & Postal History enthusiastically supports the proposal submitted by the Northeastern Federation of Stamp Clubs to stage the 2026 International Philatelic Show in Boston. Historically, the greater Boston area has been an important center for philately with dealers, auction houses, and collector clubs and organizations, as well as the location of the Spellman Museum of Stamps & Postal History.

The Spellman Museum's philatelic collections, library, exhibits, educational programs and resources have provided the Boston area with a broad base to reach out to, and engage, both philatelists and the general public of all age levels and interests.

The staff, volunteers, and resources of the Spellman Museum are available to support the USA 250 World Stamp Exhibition and show committee to insure a successful and most memorable philatelic event.

Very truly yours,

A handwritten signature in black ink that reads "George S. Norton". The signature is fluid and cursive, with a small mark at the end.

George S. Norton
Curator of Philatelic Collections
and Operations Officer

**WALTHAM STAMP CLUB
241 Wellesley Street
Weston, MA 02493**

December 24, 2014

The Waltham Stamp Club enthusiastically supports the efforts of the USA 250 Committee to bring the 2026 International Philatelic Show to Boston, Massachusetts. As one of the largest stamp clubs in New England and member of the Northeast Federation of Stamp Clubs our membership pledges its assistance in this tremendously significant endeavor. Further, our club's membership growth trend points to our ability to provide support to USA 250 not only in the short term but in the long range planning as well.

International Philatelic Show 2026 coincides with the 250th anniversary of the United States. Some of the most significant battles of America's war for independence took place in Boston and in the surrounding communities. Our club's ties to the town of Lexington, in particular, may aid us in a cooperative effort to promote both the philatelic show and local tourism.

We thank the dedicated and talented members of the USA 250 committee for their hard work and we look forward to working with you to bring the International Philatelic Show 2026 to Boston.

Sincerely,

Norm Shufrin – Waltham Stamp Club President

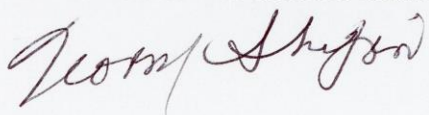
A handwritten signature in dark ink, appearing to read "Norm Shufrin", written in a cursive style.